

CM super strong anchor shackles

- These shackles have higher working load limits than specified by Federal Specifications.
- All shackle pins are forged from alloy steel, heat treated and tempered to give greater strength.
- All shackles are marked with size (inches and millimeters) and working load limit in tons.
- Ultimate strength equals 6 times working load limit. Proof load equals 2.2 times working load limit.
- All bolt, nut & cotter shackles have thread protected ends.
- When ordering, specify galvanized (G) or painted (P).
- Galvanized per ASTM A153.
- Painted shackles are orange.
- Ton = 2,000 lbs. ($\frac{3}{16}$ " – 2"), 2,200 lbs. ($2\frac{1}{2}$ " – $3\frac{1}{2}$ ").
- Standard industry tolerances apply.
- Built-in Distortion Detectors ($\frac{3}{16}$ " – 2").

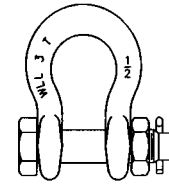
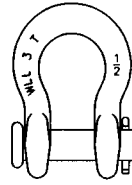
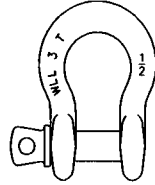

Size (in.)	Working load limit (tons)	Screw pin type			Round pin type			Bolt & nut type		
		Product code	Painted UPC 43927-	Galv. UPC 43927-	Product code	Painted UPC 43927-	Galv. UPC 43927-	Product code	Painted UPC 43927-	Galv. UPC 43927-
3/16	1/2	M645	—	40061	M345	—	40095	—	—	—
1/4	3/4	M646	40004	40062	M346	40100	40099	—	—	—
5/16	1	M647	40008	40064	M347	40105	40104	—	—	—
3/8	1 1/2	M648	40012	40066	M348	40110	40109	—	—	—
7/16	2	M649	40016	40068	M349	40115	40114	—	—	—
1/2	3	M650	40020	40070	M350	40120	40119	M850	40183	40182
5/8	4 1/2	M651	40023	40073	M351	40125	40124	M851	40186	40185
3/4	6 1/2	M652	40027	40074	M352	40130	40129	M852	40189	40188
7/8	8 1/2	M653	40031	40076	M353	40135	40134	M853	40192	40191
1	10	M654	40036	40077	M354	41950	40139	M854	40195	40194
1 1/8	12	M655	40039	40080	M355	40145	40144	M855	40198	40197
1 1/4	14	M656	40041	40082	M356	40150	40149	M856	40201	40200
1 3/8	17	M666	40044	40084	M366	40158	40157	M866	40204	40203
1 1/2	20	M657	40048	40087	M357	40164	40163	M857	40207	40206
1 5/8	24	M685	40052	40089	M385	40169	40168	M885	40210	40209
1 3/4	30	M677	40056	40091	M377	40175	40174	M877	40213	40212
2	35	M658	40060	40093	M358	40180	40179	M858	40216	40215

Dimensions (inches) apply to all styles of anchor shackles

Size	Dia. of pin P	Width between eyes W	Inside length L	Inside width at bow B (min.)	Outside dia. of eye R (max.)	Approx. weight each (lbs.)
3/16	1/4	3/8	7/8	5/8	5/8	.06
1/4	5/16	15/32	1 1/8	3/4	7/8	.12
5/16	3/8	17/32	1 1/4	13/16	1	.20
3/8	7/16	2 1/32	1 7/16	15/16	1 1/8	.30
7/16	1/2	3/4	1 11/16	1 1/16	1 1/4	.50
1/2	5/8	13/16	1 7/8	1 3/16	1 3/8	.75
5/8	3/4	1 1/16	2 3/8	1 1/2	1 7/8	1.3
3/4	7/8	1 1/4	2 13/16	1 3/4	2 1/8	2.3
7/8	1	1 7/16	3 5/16	2	2 3/8	3.5
1	1 1/8	1 11/16	3 3/4	2 5/16	2 5/8	5.0
1 1/8	1 1/4	1 13/16	4 1/4	2 5/8	2 7/8	7.0
1 1/4	1 3/8	2 1/32	4 11/16	2 7/8	3 1/4	9.5
1 3/8	1 1/2	2 1/4	5 1/4	3 1/4	3 1/2	12.5
1 1/2	1 5/8	2 3/8	5 3/4	3 3/8	3 3/4	17.2
1 5/8	1 3/4	2 5/8	6 1/4	4	4 1/8	23.5
1 3/4	2	2 7/8	7	4 1/2	4 1/2	27.7
2	2 1/4	3 1/4	7 3/4	5 1/4	5 1/4	39.0

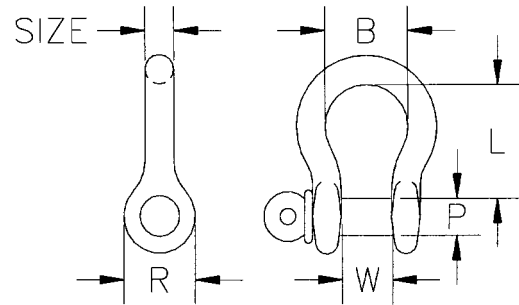

CM super strong chain shackles

- These shackles have higher working load limits than specified by Federal Specifications.
- All shackle pins are forged from alloy steel, heat treated and tempered to give greater strength.
- All shackles are marked with size (inches and millimeters) and working load limit in tons.
- Ultimate strength equals 6 times working load limit. Proof load equals 2.2 times working load limit.
- All bolt, nut & cotter shackles have thread protected ends.
- When ordering, specify galvanized (G) or painted (P).
- Galvanized per ASTM A153.
- Painted shackles are orange.
- Ton = 2,000 lbs.
- Standard industry tolerances apply.

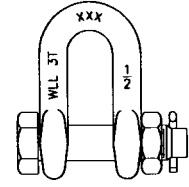
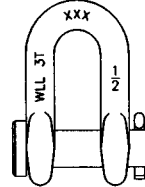
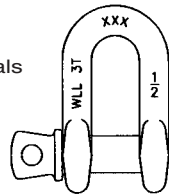

Size (in.)	Working load limit (tons)	Screw pin type			Round pin type			Bolt & nut type		
		Product code	Painted UPC 43927-	Galv. UPC 43927-	Product code	Painted UPC 43927-	Galv. UPC 43927-	Product code	Painted UPC 43927-	Galv. UPC 43927-
1/4	3/4	M746	40220	40277	M546	40304	40303	—	—	—
5/16	1	M747	40224	40278	M547	40310	40309	—	—	—
3/8	1 1/2	M748	40227	40279	M548	40316	40315	—	—	—
7/16	2	M749	40231	40280	M549	40322	40321	—	—	—
1/2	3	M750	40235	40281	M550	40328	40327	M950	40388	40387
5/8	4 1/2	M751	40239	40282	M551	40334	40333	M951	40391	40390
3/4	6 1/2	M752	40243	40283	M552	40340	40339	M952	40394	40393
7/8	8 1/2	M753	40247	40284	M553	41949	40344	M953	40397	40396
1	10	M754	40251	40285	M554	40350	40349	M954	40400	40399
1 1/8	12	M755	40254	40289	M555	40355	40354	M955	40403	40402
1 1/4	14	M756	40257	40287	M556	40360	40359	M956	40406	40405
1 3/8	17	M766	40261	40291	M566	40365	40364	M966	40409	40408
1 1/2	20	M757	40264	40293	M557	40370	40369	M957	40412	40411
1 5/8	24	M785	40268	40295	M585	40375	40374	M985	40415	40414
1 3/4	30	M777	40272	40297	M577	40380	40379	M977	40418	40417
2	35	M758	40276	40299	M558	40385	40384	M958	40421	40420

Dimensions (inches) apply to all styles of chain shackles

Size	Dia. of pin P	Width between eyes W	Inside length L	Outside dia. of eye R (max.)	Approx. weight each (lbs.)
1/4	5/16	15/32	1 1/8	7/8	.12
5/16	3/8	17/32	1 1/4	1	.20
3/8	7/16	21/32	1 7/16	1 1/8	.30
7/16	1/2	3/4	1 11/16	1 1/4	.50
1/2	5/8	13/16	1 7/8	1 3/8	.75
5/8	3/4	1 1/16	2 3/8	1 7/8	1.3
3/4	7/8	1 1/4	2 13/16	2 1/8	2.3
7/8	1	1 7/16	3 5/16	2 3/8	3.5
1	1 1/8	1 11/16	3 3/4	2 5/8	5.0
1 1/8	1 1/4	1 13/16	4 1/4	2 7/8	7.0
1 1/4	1 3/8	2 1/32	4 11/16	3 1/4	9.5
1 3/8	1 1/2	2 1/4	5 1/4	3 1/2	12.5
1 1/2	1 5/8	2 3/8	5 3/4	3 3/4	17.2
1 5/8	1 3/4	2 5/8	6 1/4	4 1/8	23.5
1 3/4	2	2 7/8	7	4 1/2	27.7
2	2 1/4	3 1/4	7 3/4	5 1/4	39.0

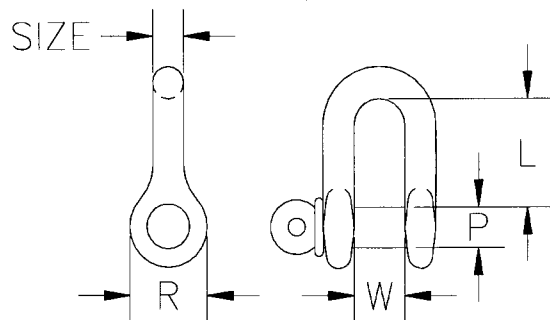

*** ⚠ WARNING**

TO AVOID INJURY:

- Do not exceed working load limit.

CM alloy steel anchor shackles

- These galvanized shackles meet all requirements of Federal Specification RR-C-271D Amendment 1 except as noted.
 - All shackle bodies and pins are forged from alloy steel, heat treated and tempered to give greater strength and abrasion resistance.
 - All shackles are marked with size (inches and millimeters) and working load limit in tons.
 - Ultimate strength equals 5 times working load limit. Proof load equals 2.2 times working load limit.
 - All bolt, nut & cotter shackles have thread protected ends and are 100% proof tested.
 - When ordering, specify galvanized (G) or painted (P).
 - Galvanized per ASTM A153.
 - Painted shackles are orange.
 - Ton = 2,000 lbs. ($\frac{3}{8}$ " – 2"), 2,200 lbs. ($2\frac{1}{2}$ " – $3\frac{1}{2}$ ").
 - Standard industry tolerances apply.
 - Built-in Distortion Detectors ($\frac{3}{8}$ " – 2").
 - $2\frac{1}{2}$ " – $3\frac{1}{2}$ " Shackles may be imported.
 - Round pin type available on request.
- * = These shackles do not meet Federal Specification RR-C-271D Amendment 1.

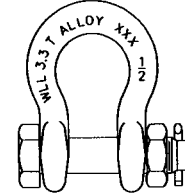
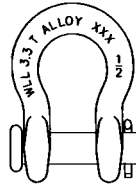
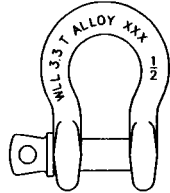

Size (in.)	Working load limit (tons)	Screw pin type			Round pin type			Bolt & nut type			
		Product code	Painted UPC 43927-	Galv. UPC 43927-	Product code	Painted UPC 43927-	Galv. UPC 43927-	Working load limit (tons)	Product code	Painted UPC 43927-	Galv. UPC 43927-
3/8	2	M648A	40433	40499	—	—	—	—	—	—	—
7/16	25/8	M649A	40440	40501	—	—	—	—	—	—	—
1/2	3 1/3	M650A	40447	40503	M350A	46081	45046	3 1/3	M850A	40553	40552
5/8	5	M651A	40454	40505	M351A	46083	46103	5	M851A	40556	40555
3/4	7	M652A	40459	40507	M352A	46085	46104	7	M852A	40559	40558
7/8	9 1/2	M653A	40464	40509	M353A	46087	46105	9 1/2	M853A	40562	40561
1	12 1/2	M654A	40469	40511	M354A	46089	44321	12 1/2	M854A	40565	40564
1 1/8	15	M655A	40473	40513	M355A	46091	46237	15	M855A	40568	40567
1 1/4	18	M656A	40477	40515	M356A	46093	44982	8	M856A	40571	40570
1 3/8	21	M666A	40481	40517	M366A	46099	44911	21	M866A	40574	40573
1 1/2	25	M657A*	40485	40519	M357A*	46095	46079	30	M857A	40577	40576
1 5/8	29	M685A*	40489	40488	M385A*	46106	45072	35	M885A	40580	40579
1 3/4	34	M677A*	40493	40523	M377A*	46101	45300	40	M877A	40583	40582
2	43	M658A*	40497	40525	M358A*	46097	44983	50	M858A	40586	40517
2 1/2	—	—	—	—	—	—	—	80	M860AG*	—	45763
3	—	—	—	—	—	—	—	110	MC862AG	—	46305
3 1/2	—	—	—	—	—	—	—	140	M864AG*	—	45767

Dimensions (inches) apply to all styles of anchor shackles

Size	Dia. of pin P	Width between eyes W	Inside length L	Inside width at bow B (min.)	Outside dia. of eye R (max.)	Approx. weight each (lbs.)
3/8	7/16	21/32	17/16	15/16	1 1/8	.30
7/16	1/2	3/4	1 1/16	1 1/16	1 1/4	.50
1/2	5/8	13/16	1 7/8	1 3/16	1 3/8	.75
5/8	3/4	1 1/16	2 3/8	1 1/2	1 7/8	1.3
3/4	7/8	1 1/4	2 13/16	1 3/4	2 1/8	2.3
7/8	1	1 7/16	3 5/16	2	2 3/8	3.5
1	1 1/8	1 11/16	3 3/4	2 5/16	2 5/8	5.0
1 1/8	1 1/4	1 13/16	4 1/4	2 5/8	2 7/8	7.0
1 1/4	1 3/8	2 1/32	4 11/16	2 7/8	3 1/4	9.5
1 3/8	1 1/2	2 1/4	5 1/4	3 1/4	3 1/2	12.5
1 1/2	1 5/8	2 3/8	5 3/4	3 3/8	3 3/4	17.2
1 5/8	1 3/4	2 5/8	6 1/4	4	4 1/8	23.5
1 3/4	2	2 7/8	7	4 1/2	4 1/2	27.7
2	2 1/4	3 1/4	7 3/4	5 1/4	5 1/4	39.0
2 1/2	2 3/4	4 1/4	10 1/2	6 3/4	6 1/4	90.0
3	3 1/4	5	13	7 3/8	6 3/4	137.0
3 1/2	3 3/4	5 3/4	15	9	8 1/2	242.0

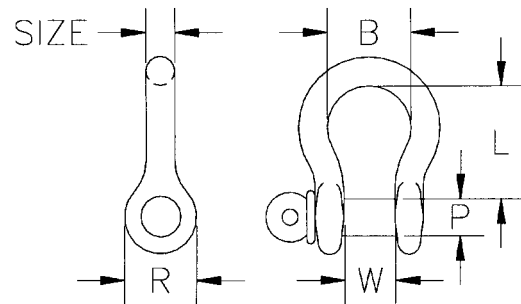

CM alloy steel chain shackles

- These galvanized shackles meet all requirements of Federal Specification RR-C-271D Amendment 1 except as noted.
 - All shackle bodies and pins are forged from alloy steel, heat treated and tempered to give greater strength and abrasion resistance.
 - All shackles are marked with size (inches and millimeters) and working load limit in tons.
 - Ultimate strength equals 5 times working load limit. Proof load equals 2.2 times working load limit.
 - All bolt, nut & cotter shackles have thread protected ends.
 - When ordering, specify galvanized (G) or painted (P).
 - Galvanized per ASTM A153.
 - Painted shackles are orange.
 - Ton = 2,000 lbs.
 - Standard industry tolerances apply.
 - Availability on request.
- * = These shackles do not meet Federal Specification RR-C-271D Amendment 1.

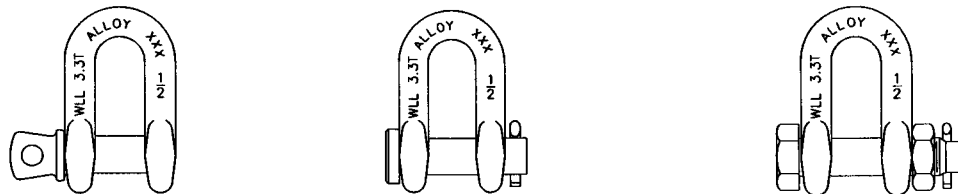

Size (in.)	Working load limit (tons)	Screw pin type			Round pin type			Bolt & nut type			
		Product code	Painted UPC 43927-	Galv. UPC 43927-	Product code	Painted UPC 43927-	Galv. UPC 43927-	Working load limit (tons)	Product code	Painted UPC 43927-	Galv. UPC 43927-
3/8	2	M748A	46112	46113	—	—	—	—	—	—	—
7/16	2 5/8	M749A	46128	46116	—	—	—	—	—	—	—
1/2	3 1/3	M750A	46118	46119	M550A	46149	44965	3 1/3	M950A	46173	44964
5/8	5	M751A	46121	45056	M551A	46151	44328	5	M951A	46175	44904
3/4	7	M752A	46124	44349	M552A	46153	44329	7	M952A	46177	46227
7/8	9 1/2	M753A	46127	44395	M553A	46155	46231	9 1/2	M953A	46179	45380
1	12 1/2	M754A	46130	46122	M554A	46157	46232	12 1/2	M954A	46181	45386
1 1/8	15	M755A	46132	45723	M555A	46159	46233	15	M955A	46183	46228
1 1/4	18	M756A	46134	45513	M556A	46161	46234	8	M956A	46185	45942
1 3/8	21	M766A	46139	46226	M566A	46167	46235	21	M966A	46191	46229
1 1/2	25	M757A*	46136	45155	M557A*	46163	46236	30	M957A	46187	44355
1 5/8	29	M785A*	46144	45690	M585A*	46171	44908	35	M985A	46195	46230
1 3/4	34	M777A*	46142	46125	M577A*	46169	44330	40	M977A	46193	44397
2	43	M758A*	46138	44350	M558A*	46165	44381	50	M958A	46189	45292

Dimensions (inches) apply to all styles of chain shackles

Size	Dia. of pin P	Width between eyes W	Inside length L	Outside dia. of eye R (max.)	Approx. weight each (lbs.)
3/8	7/16	2 1/32	1 7/16	1 1/8	.30
7/16	1/2	3/4	1 11/16	1 1/4	.50
1/2	5/8	13/16	1 7/8	1 3/8	.75
5/8	3/4	1 1/16	2 3/8	1 7/8	1.3
3/4	7/8	1 1/4	2 13/16	2 1/8	2.3
7/8	1	1 7/16	3 5/16	2 3/8	3.5
1	1 1/8	1 11/16	3 3/4	2 5/8	5.0
1 1/8	1 1/4	1 13/16	4 1/4	2 7/8	7.0
1 1/4	1 3/8	2 1/32	4 11/16	3 1/4	9.5
1 3/8	1 1/2	2 1/4	5 1/4	3 1/2	12.5
1 1/2	1 5/8	2 3/8	5 3/4	3 3/4	17.2
1 5/8	1 3/4	2 5/8	6 1/4	4 1/8	23.5
1 3/4	2	2 7/8	7	4 1/2	27.7
2	2 1/4	3 1/4	7 3/4	5 1/4	39.0

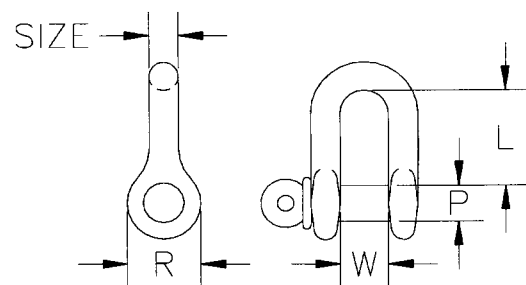

*** ⚠ WARNING**

TO AVOID INJURY:

- Do not exceed working load limit.

CM industrial/government rated anchor shackles

- These shackles meet requirements of Federal Specification RR-C-271D Amendment 1.
- All shackle pins are forged from alloy steel, heat treated and tempered to give greater strength.
- All shackles are marked with size (inches and millimeters) and working load limit in tons.
- Ultimate strength equals 5 times working load limit. Proof load equals 2.2 times working load limit.
- All bolt, nut & cotter shackles have thread protected ends.
- Galvanized per ASTM A153.
- Ton = 2,000 lbs.
- Standard industry tolerances apply.
- 2½" – 3½" Shackles may be imported – Ultimate strength equals 5 times working load limit.

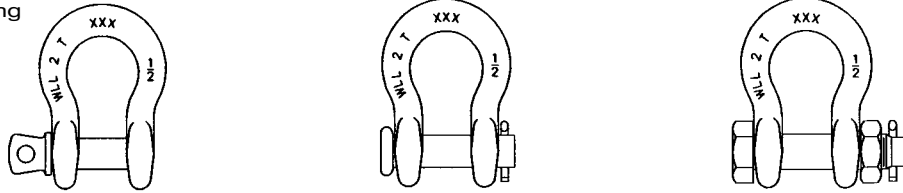

Size (in.)	Working load limit (tons)	Screw pin type		Round pin type		Bolt & nut type	
		Product code	Galv. UPC 43927-	Product code	Galv. UPC 43927-	Product code	Galv. UPC 43927-
3/16	1/3	MC645G	45390	MC345G	46252	—	—
1/4	1/2	MC646G	45809	MC346G	46253	—	—
5/16	3/4	MC647G	45393	MC347G	46254	—	—
3/8	1	MC648G	45810	MC348G	46255	—	—
7/16	1 1/2	MC649G	45811	MC349G	46256	—	—
1/2	2	MC650G	45812	MC350G	46257	MC850G	45861
5/8	3 1/4	MC651G	45813	MC351G	46258	MC851G	45862
3/4	4 3/4	MC652G	45814	MC352G	46259	MC852G	45863
7/8	6 1/2	MC653G	45815	MC353G	46260	MC853G	45864
1	8 1/2	MC654G	45816	MC354G	46261	MC854G	45865
1 1/8	9 1/2	MC655G	45817	MC355G	46262	MC855G	45866
1 1/4	12	MC656G	45818	MC356G	45403	MC856G	45404
1 3/8	13 1/2	MC666G	45819	MC366G	45407	MC866G	45408
1 1/2	17	MC657G	45396	MC357G	45411	MC857G	45412
1 5/8	20	MC685G	45820	MC385G	46263	MC885G	46245
1 3/4	25	MC677G	45400	MC377G	45415	MC877G	45416
2	35	M658G	40093	M358G	40179	M858G	40215
2 1/2	55	—	—	—	—	M860G	45762
3	85	—	—	—	—	M862G	45764
3 1/2	120	—	—	—	—	M864G	45766

Dimensions (inches) apply to all styles of anchor shackles

Size	Dia. of pin P	Width between eyes W	Inside length L	Inside width at bow B (min.)	Outside dia. of eye R (max.)	Approx. weight each (lbs.)
3/16	1/4	3/8	7/8	5/8	5/8	.06
1/4	5/16	15/32	1 1/8	3/4	7/8	.12
5/16	3/8	17/32	1 1/4	13/16	1	.20
3/8	7/16	21/32	1 7/16	15/16	1 1/8	.30
7/16	1/2	3/4	1 11/16	1 1/16	1 1/4	.50
1/2	5/8	13/16	1 7/8	1 3/16	1 3/8	.75
5/8	3/4	1 1/16	2 3/8	1 1/2	1 7/8	1.3
3/4	7/8	1 1/4	2 13/16	1 3/4	2 1/8	2.3
7/8	1	1 7/16	3 5/16	2	2 3/8	3.5
1	1 1/8	1 11/16	3 3/4	2 5/16	2 5/8	5.0
1 1/8	1 1/4	1 13/16	4 1/4	2 5/8	2 7/8	7.0
1 1/4	1 3/8	2 1/32	4 11/16	2 7/8	3 1/4	9.5
1 3/8	1 1/2	2 1/4	5 1/4	3 1/4	3 1/2	12.5
1 1/2	1 5/8	2 3/8	5 3/4	3 3/8	3 3/4	17.2
1 5/8	1 3/4	2 5/8	6 1/4	4	4 1/8	23.5
1 3/4	2	2 7/8	7	4 1/2	4 1/2	27.7
2	2 1/4	3 1/4	7 3/4	5 1/4	5 1/4	39.0
2 1/2	2 3/4	4 1/4	10 1/2	6 3/4	6 1/4	90.0
3	3 1/4	5	13	7 3/8	6 3/4	137.0
3 1/2	3 3/4	5 3/4	15	9	8 1/2	242.0

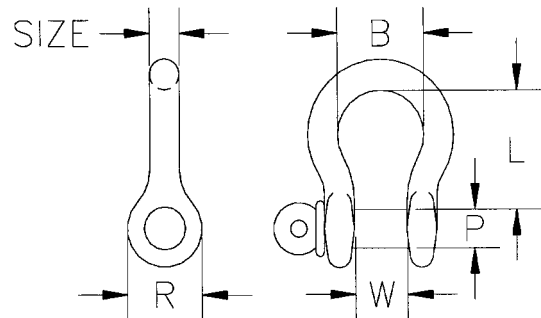

CM industrial/government rated chain shackles

- These shackles meet requirements of Federal Specification RR-C-271D Amendment 1.
- All shackle pins are forged from alloy steel, heat treated and tempered to give greater strength.
- All shackles are marked with size (inches and millimeters) and working load limit in tons.
- Ultimate strength equals 5 times working load limit. Proof load equals 2.2 times working load limit.
- All bolt, nut & cotter shackles have thread protected ends.
- Galvanized per ASTM A153.
- Ton = 2,000 lbs.
- Standard industry tolerances apply.

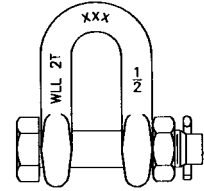
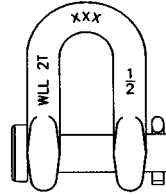
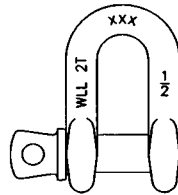

Size (in.)	Working load limit (tons)	Screw pin type		Round pin type		Bolt & nut type	
		Product code	Galv. UPC 43927-	Product code	Galv. UPC 43927-	Product code	Galv. UPC 43927-
1/4	1/2	MC746G	45419	MC546G	45422	—	—
5/16	3/4	MC747G	45425	MC547G	45428	—	—
3/8	1	MC748G	45431	MC548G	45434	—	—
7/16	1 1/2	MC749G	45437	MC549G	45440	—	—
1/2	2	MC750G	46238	MC550G	45444	MC950G	46246
5/8	3 1/4	MC751G	46239	MC551G	46264	MC951G	46247
3/4	4 3/4	MC752G	46240	MC552G	46265	MC952G	46248
7/8	6 1/2	MC753G	46241	MC553G	45448	MC953G	46249
1	8 1/2	MC754G	46242	MC554G	45451	MC954G	46250
1 1/8	9 1/2	MC755G	45454	MC555G	45457	MC955G	45458
1 1/4	12	MC756G	46243	MC556G	45461	MC956G	45462
1 3/8	13 1/2	MC766G	45465	MC566G	45468	MC966G	45469
1 1/2	17	MC757G	45472	MC557G	45475	MC957G	45476
1 5/8	20	MC785G	46244	MC585G	46266	MC985G	46251
1 3/4	25	MC777G	45480	MC577G	45483	MC977G	45484
2	35	M758G	40299	M558G	40384	M958G	40420

Dimensions (inches) apply to all styles of chain shackles

Size	Dia. of pin P	Width between eyes W	Inside length L	Outside dia. of eye R (max.)	Approx. weight each (lbs.)
1/4	5/16	15/32	1 1/8	7/8	.12
5/16	3/8	17/32	1 1/4	1	.20
3/8	7/16	21/32	1 7/16	1 1/8	.30
7/16	1/2	3/4	1 11/16	1 1/4	.50
1/2	5/8	13/16	1 7/8	1 3/8	.75
5/8	3/4	1 1/16	2 3/8	1 7/8	1.3
3/4	7/8	1 1/4	2 13/16	2 1/8	2.3
7/8	1	1 7/16	3 5/16	2 3/8	3.5
1	1 1/8	1 11/16	3 3/4	2 5/8	5.0
1 1/8	1 1/4	1 13/16	4 1/4	2 7/8	7.0
1 1/4	1 3/8	2 1/32	4 11/16	3 1/4	9.5
1 3/8	1 1/2	2 1/4	5 1/4	3 1/2	12.5
1 1/2	1 5/8	2 3/8	5 3/4	3 3/4	17.2
1 5/8	1 3/4	2 5/8	6 1/4	4 1/8	23.5
1 3/4	2	2 7/8	7	4 1/2	27.7
2	2 1/4	3 1/4	7 3/4	5 1/4	39.0

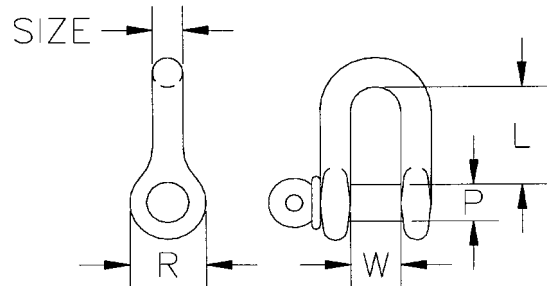

*** ⚠ WARNING**

TO AVOID INJURY:

- Do not exceed working load limit.

Dixie anchor shackles with screw pin

- Commercial grade
- Hot galvanized
- Imported

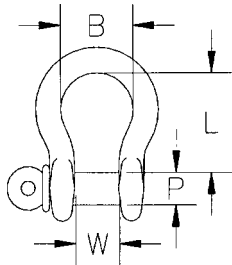

Size dia. D (in.)	Working load limit (tons)*	Product code	Std. pack	Dimensions (inches)				Approx. weight each (lbs.)
				Dia. of pin P	Width between eyes W	Inside length L	Inside width at bow B (min.)	
3/16	1/4	07722	25	15/64	21/64	15/16	5/8	1.1
1/4	1/3	07723	25	19/64	1/2	15/32	25/32	2.1
5/16	1/2	07724	25	3/8	15/32	1 1/8	13/16	3.2
3/8	3/4	07725	25	15/32	5/8	127/64	11/32	4.9
1/2	1 1/2	07726	25	5/8	25/32	157/64	19/32	9.2

Ton = 2,000 lbs.

CM trawling shackle

- Heat treated bodies.
- Heat treated alloy pins.
- Square head pins for convenience in wrench tightening and loosening.
- Proof load 2.2 times working load limit.
- Ultimate strength 6 times working load limit.
- Painted orange.

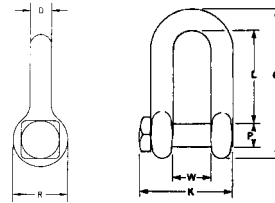
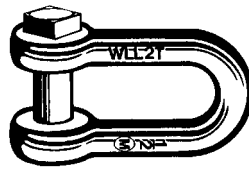

Size dia. D (in.)	Working load limit (tons)*	Product code	UPC 43927-	Dimensions (inches)						Tolerance plus or minus		Approx. weight each (lbs.)
				P	W	L	O	R	K	L	W	
1/2	3	M450	40593	5/8	13/16	111/16	3 1/8	1 1/4	2 1/16	1/16	1/16	.6
5/8	4 1/2	M451	40594	3/4	1 1/16	2	3 13/16	1 1/2	2 5/8	1/8	1/16	1.3
3/4	6 1/2	M452	40595	7/8	1 1/4	2 3/8	4 7/16	1 7/8	3 1/8	1/4	1/16	2.2
7/8	8 1/2	M453	40596	1	1 7/16	2 13/16	5 5/16	2 1/8	3 5/8	1/4	1/16	3
1	10	M454	40597	1 1/8	1 11/16	3 3/16	6	2 3/8	4 3/16	1/4	1/16	4.5

Ton = 2,000 lbs.

CM kiln shackle

- Available in carbon steel, alloy steel or stainless steels. State grade.
- Various shackle closures available (loose pin for welding; hex head screw pin; bolt and full nut).
- All shackle pins available in three (3) diameters in match with type of service.
- Bodies and pins available separately.
- General usage: Carbon steel—up to 750°F. Alloy steel—750°F to 1000°F. Stainless steel—1000°F and up.
- Carbon and alloy steels can be heat treated to your specification (400 BHN max.).
- Minor modifications to dimensions W, L and B can be made at your request.
- Special shackle designs quoted at your request.

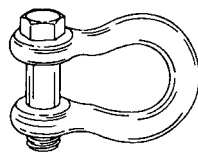

Hex head screw pin

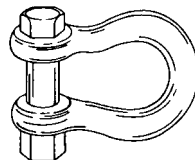

Full nut & bolt

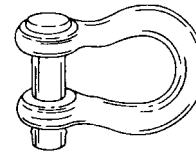

Loose pin

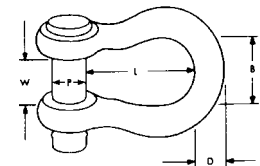

Standard sizes—dimensions (inches)							
Diameter of pin P	Width between eyes W	Inside length L	Inside width at bow B	Outside diameter of eye	Tolerance plus or minus		Approx. weight each (lbs.)
					L	W	
3/4	1 1/4	3	2	1 7/8	1/4	1/16	2.25
7/8	1 1/4	3	2	1 7/8	1/4	1/16	2.25
5/8	1 1/4	3	2	1 7/8	1/4	1/16	2.25
7/8	1 7/16	3 1/4	2 5/16	2 1/8	1/4	1/16	3.50
1	1 7/16	3 1/4	2 5/16	2 1/8	1/4	1/16	3.50
3/4	1 7/16	3 1/4	2 5/16	2 1/8	1/4	1/16	3.50
1	1 11/16	3 3/4	2 9/16	2 3/8	1/4	1/16	5.00
1 1/8	1 11/16	3 3/4	2 9/16	2 3/8	1/4	1/16	5.00
7/8	1 11/16	3 3/4	2 9/16	2 3/8	1/4	1/16	5.00
1 1/8	1 13/16	4 1/4	2 15/16	2 5/8	1/4	1/16	7.00
1 1/4	1 13/16	4 1/4	2 15/16	2 5/8	1/4	1/16	7.00
1	1 13/16	4 1/4	2 15/16	2 5/8	1/4	1/16	7.00

When ordering, specify carbon, alloy or stainless steel (state grade), whether screw pin, nut and bolt or loose pin is required, plus body and pin diameters. Also, state whether you require complete shackles, body only or pin only.

All items self colored unless otherwise specified.

CM stainless steel screw pin anchor shackle

- Drop forged using 304 stainless steel material.
- Non-magnetic and corrosion resistant.
- Permanently marked with raised characters for identification, "NM" or "SS" stainless steel.
- Polished for improved appearance and to enhance corrosion and chemical resistance.
- Proof load is 2 times working load limit. Ultimate load is 5 times working load limit.

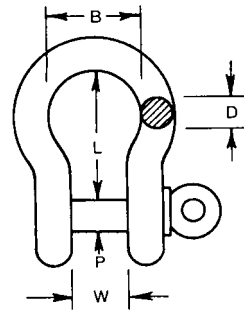

Working load limit (lbs.) min.*	Product code	UPC 43927-	Dimensions (inches)					Approx. weight each (lbs.)
			Size D	Pin P	W	L	B	
720	M646S	40424	1/4	5/16	15/32	1 1/8	13/16	.10
1,060	M647S	40427	5/16	3/8	17/32	1 1/4	7/8	.16
1,600	M648S	40434	3/8	7/16	21/32	1 7/16	1 1/16	.31
2,200	M649S	40441	7/16	1/2	23/32	1 11/16	1 1/4	.50
2,800	M650S	40448	1/2	5/8	13/16	1 15/16	1 7/16	.72
4,400	M651S	40455	5/8	3/4	1 1/16	2 13/32	1 3/4	1.38

NOTE: Normal shackle tolerances apply.

CM web sling shackle

- Finish: hot dip galvanized.
- Klik pin (zinc plated) as shown furnished as standard—cotter or hair pin can be furnished on special order.
- Shackle body: carbon steel, heat treated.
- Shackle pin: alloy steel, heat treated.
- Tolerances: $\pm 1/32$ " unless otherwise indicated.
- Design ultimate strength equals 4 times the working load limit.

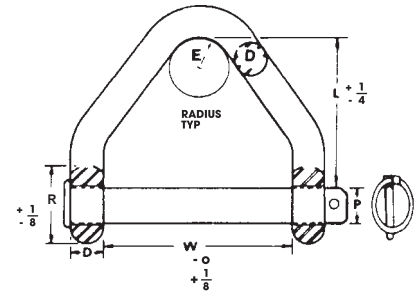
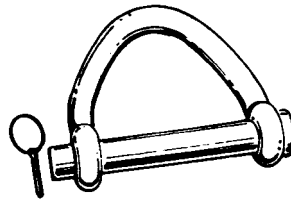

Webbing width (in.)	Working load limit (lbs.)*	Shackle			KLIK pin code	Dimensions (inches)						Approx. weight each (lbs.)
		Product code	UPC 43927-	Radius E		W	L	D	P	R		
2	8,050	M702	40600	333001	2	2 1/4	5/8	3/4	1 5/8	5/8	1.70	
3	13,050	M703	40603	333001	3	3 1/4	3/4	7/8	1 7/8	3/4	2.86	
4	10,800	M704	40606	333001	4	3 3/4	3/4	7/8	1 7/8	7/8	3.15	
5	18,000	M705	40609	333002	5	4 1/4	7/8	1	2 1/8	7/8	4.75	
6	18,000	M706	40614	333002	6	4 3/4	1	1 1/8	2 3/8	1	6.75	
6	23,850	M706H heavy duty	40615	333002	6	4 3/4	1 1/8	1 1/4	2 5/8	1	9.80	

* ⚠ WARNING

TO AVOID INJURY:

- Do not exceed working load limit.



HALO

YOKE SAFETY ANCHOR SHACKLES



ABS
Type Approval



Yoke Part No.	Nominal Size	Working Load Limit 6:1 safety factor	Dimensions (inch)							Wt. Lbs
			W	D	A	B	E	G	H	
8-838-08	5/16	0.75	0.51	0.37	1.22	0.31	0.87	0.75	2.09	0.2
8-838-10	3/8	1	0.63	0.43	1.42	0.39	1.02	0.91	2.56	0.3
8-838-11	7/16	1.5	0.75	0.51	1.69	0.43	1.18	1.06	2.95	0.4
8-838-13	1/2	2	0.79	0.63	1.85	0.51	1.3	1.18	3.35	0.7
8-838-16	5/8	3.25	1.06	0.75	2.4	0.63	1.77	1.54	4.21	1.4
8-838-19	3/4	4.75	1.3	0.87	2.83	0.75	2.05	1.85	5.04	2.4
8-838-22	7/8	6.5	1.5	1.02	3.31	0.87	2.28	2.13	5.91	3.6
8-838-26	1	8.5	1.73	1.1	3.78	1.02	2.72	2.44	6.57	5
8-838-28	1 1/8	9.5	1.81	1.26	4.27	1.1	2.91	2.72	7.52	7.4
8-838-32	1 1/4	12	2.17	1.42	4.61	1.26	3.35	2.99	8.27	9.5
8-838-36	1 3/8	13.5	2.24	1.5	5.28	1.42	3.7	3.35	9.13	13.5
8-838-38	1 1/2	17	2.38	1.63	5.57	1.5	3.88	3.63	10	17.2

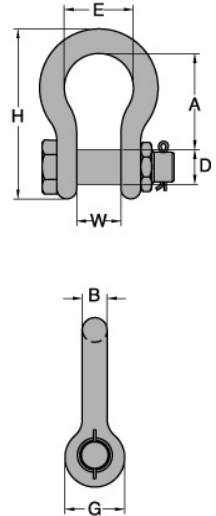

YOKE ALLOY SAFETY ANCHOR SHACKLES



ABS
Type Approval



Yoke Part No.	Nominal Size	Working Load Limit 6:1 safety factor	Dimensions (inch)							Wt. Lbs
			W	D	A	B	E	G	H	
8-808-10	3/8	2	0.63	0.43	1.42	0.39	1.02	0.91	2.56	0.3
8-808-11	7/16	2.6	0.75	0.51	1.69	0.43	1.18	1.06	2.95	0.5
8-808-13	1/2	3.4	0.79	0.63	1.85	0.51	1.3	1.18	3.35	0.8
8-808-16	5/8	5	1.06	0.75	2.4	0.63	1.77	1.54	4.21	1.7
8-808-19	3/4	7	1.3	0.87	2.8	0.75	1.97	1.81	4.96	2.7
8-808-22	7/8	9.5	1.5	1.02	3.31	0.87	2.28	2.09	5.83	3.9
8-808-26	1	12.5	1.73	1.1	3.74	1.02	2.68	2.36	6.54	5.6
8-808-28	1 1/8	15	1.81	1.26	4.25	1.1	2.91	2.68	7.48	8.2
8-808-32	1 1/4	18	2.17	1.42	4.69	1.26	3.23	2.99	8.27	11.7
8-808-36	1 3/8	21	2.24	1.5	5.24	1.42	3.62	3.31	9.13	15.8
8-808-38	1 1/2	30	2.38	1.63	5.75	1.5	3.88	3.63	10	20.8

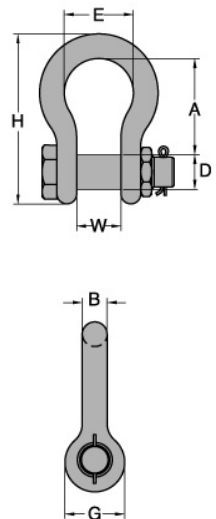



HALO

YOKE SCREW PIN ANCHOR SHACKLES



ABS
Type Approval



Yoke Part No.	Nominal Size	Working Load Limit	Dimensions (inch)							Wt. Lbs
		6:1 safety factor	W	D	A	B	E	G	H	
	inch	tons								
8-837-08	5/16	0.75	0.51	0.37	1.22	0.31	0.87	0.75	2.09	0.2
8-837-10	3/8	1	0.63	0.43	1.42	0.39	1.02	0.91	2.56	0.3
8-837-11	7/16	1.5	0.75	0.51	1.69	0.43	1.18	1.06	2.95	0.4
8-837-13	1/2	2	0.79	0.63	1.85	0.51	1.3	1.18	3.35	0.7
8-837-16	5/8	3.25	1.06	0.75	2.4	0.63	1.77	1.54	4.21	1.4
8-837-19	3/4	4.75	1.3	0.87	2.83	0.75	2.05	1.85	5.04	2.4
8-837-22	7/8	6.5	1.5	1.02	3.31	0.87	2.28	2.13	5.91	3.6
8-837-26	1	8.5	1.73	1.1	3.78	1.02	2.72	2.44	6.57	5
8-837-28	1 1/8	9.5	1.81	1.26	4.29	1.1	2.91	2.72	7.52	7.4
8-837-32	1 1/4	12	2.17	1.42	4.61	1.26	3.35	2.99	8.07	9.5
8-837-36	1 3/8	13.5	2.24	1.5	5.28	1.42	3.7	3.35	9.13	13.5
8-837-38	1 1/2	17	2.38	1.63	5.75	1.5	3.88	3.63	10	17.2

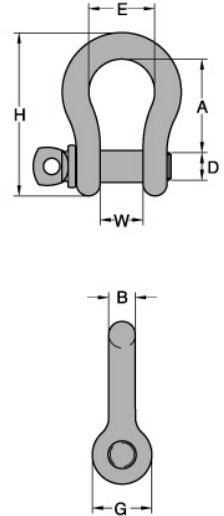

YOKE ALLOY SAFETY ANCHOR SHACKLES



ABS
Type Approval



Yoke Part No.	Nominal Size	Working Load Limit	Dimensions (inch)							Wt. Lbs
		6:1 safety factor	W	D	A	B	E	G	H	
	inch	tons								
8-807-08	5/16	1.2	0.51	0.37	1.22	0.31	0.87	0.75	2.09	0.2
8-807-10	3/8	2	0.63	0.43	1.42	0.39	1.02	0.91	2.56	0.3
8-807-11	7/16	2.6	0.75	0.51	1.69	0.43	1.18	1.06	2.95	0.4
8-807-13	1/2	3.3	0.79	0.63	1.85	0.51	1.3	1.18	3.35	0.7
8-807-16	5/8	5	1.06	0.75	2.4	0.63	1.77	1.54	4.21	1.4
8-807-19	3/4	7	1.3	0.87	2.83	0.75	2.05	1.85	5.04	2.4
8-807-22	7/8	9.8	1.5	1.02	3.31	0.87	2.28	2.13	5.91	3.6
8-807-26	1	12.5	1.73	1.1	3.78	1.02	2.72	2.44	6.57	5
8-807-28	1 1/8	15	1.81	1.26	4.29	1.1	2.91	2.72	7.52	7.4
8-807-32	1 1/4	18	2.17	1.42	4.61	1.26	3.35	2.99	8.07	9.9
8-807-36	1 3/8	21	2.24	1.5	5.28	1.42	3.7	3.35	9.13	13.5

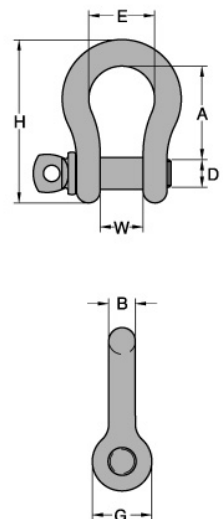



HALO

VAN BEEST SCREW PIN & BOLT TYPE SHACKLES



Green Pin®

Made in Holland



Working Load Limit	Diameter Bow	Diameter Pin	Inside Width	Inside Length		Width of Bow	Approximate Weight Each	
				Chain Type	Anchor		in lbs.	
	D	d	a	c	c	2r		
tons	inch	inch	inch	inch	inch	inch	Screw Pin	Safety Pin
0.33	3/16	1/4	3/8	3/4	7/8	5/8	0.07	
0.5	1/4	5/16	15/32	1	1 1/8	3/4	0.11	0.12
0.75	5/16	3/8	17/32	1 1/8	1 1/4	7/8	0.18	0.22
1	3/8	7/16	21/32	1 1/4	1 7/16	1	0.31	0.37
1.5	7/16	1/2	23/32	1 1/2	1 11/16	1	0.42	0.53
2	1/2	5/8	13/16	1 11/16	1 15/16	1 1/4	0.75	0.84
3.25	5/8	3/4	1 1/16	2	2 1/2	1 3/4	1.39	1.54
4.75	3/4	7/8	1 1/4	2 5/16	3	2	2.09	2.20
6.5	7/8	1	1 7/16	2 7/8	3 1/4	2 1/4	3.42	3.75
8.5	1	1 1/8	1 11/16	3 1/4	3 3/4	2 5/8	5.07	5.73
9.5	1 1/8	1 1/4	1 13/16	3 1/2	4 1/4	3	7.14	8.38
12	1 1/4	1 3/8	2	3 11/16	4 1/2	3 1/4	9.70	10.58
13.5	1 3/8	1 1/2	2 1/4	4 1/2	5 1/4	3 5/8	13.23	15.43
17	1 1/2	1 5/8	2 3/8	5	5 3/4	3 7/8	16.53	18.74
25	1 3/4	2	2 7/8	5 7/8	7	5	30.86	35.27
35	2	2 1/4	3 1/4	6 3/4	7 3/4	5 3/4	41.67	46.30
55	2 1/2	2 3/4	4 1/8	8	10	7 3/8	81.90	92.59
85	3	3 1/4	5	9 1/16	13	7 1/2		152.12
120	3 1/2	3 3/4	5 3/4	10 17/32	15	9 3/8		264.55

- Material: High Tensile Steel; Quenched & Tempered; Upset Forged
- Safety Factor: 6 times Working Load Limit = Minimum Breaking Strength
- Finish: Galvanized
- Standard: U.S. Federal Specification RR-C-271

150	4	4 1/4	6 1/2		15 3/4	10 13/16		352
200	4 3/4	5 1/8	6 7/8		19 11/16	11 7/16		518
250	4 7/8	5 1/2	7 7/8		21 1/4	12		628
300	5 5/16	5 7/8	7 7/8		23 5/8	12		749
400	6 1/2	6 7/8	8 7/8		25 19/32	12 13/16		1234
500	6 7/8	7 1/4	9 7/8		27 9/16	13 3/4		1509
600	7 5/8	8 1/6	10 7/8		27 9/16	14 3/4		1938
700	8 1/16	8 1/2	11 13/16		27 9/16	15 3/4		2247
800	8 1/4	8 5/8	11 13/16		27 9/16	15 3/4		2423
900	8 5/8	9 1/6	12 5/8		27 9/16	16 1/2		2819
1000	9 1/6	9 7/16	13 3/8		27 9/16	16 1/2		3216

- Material: Body & Pin Alloy Steel; Quenched & Tempered; Upset Forged
- Safety Factor: 5 times Working Load Limit = Minimum Breaking Strength
- Finish: Painted
- Forging Tolerances: on inside width and length 5%.
- Proofload test certificate: Lloyd's Register of Shipping plus ultrasound inspected.

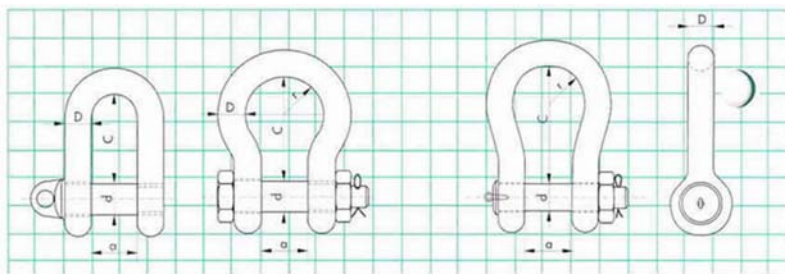

⚠ Never Exceed Working Load Limit

Do not use screw pin shackles if the pin can roll under load and unscrew.



HALO

VAN BEEST SUPER ALLOY SHACKLES



Green Pin®

Made in Holland



Working Load Limit	Diameter Bow	Diameter Pin	Inside Width	Inside Length	Width of Bow	Approx. Wt.
				Anchor Type		
	D	d	a	c	2r	in lbs.
tons	inch	inch	inch	inch	inch	
30	1 1/2	1 5/8	2 3/8	5 3/4	3 7/8	18.74
40	1 3/4	2	2 7/8	7	5	35.27
50	2	2 1/4	3 1/4	7 3/4	5 3/4	46.30
80	2 1/2	2 3/4	4 1/8	10 1/2	7 3/8	92.59
110	3	3 1/4	5	13	7 1/2	152.12
140	3 1/2	3 3/4	5 3/4	15	9 3/8	264.55
175	4	4 1/4	6 1/2	17	11	350.00

- Material: Chrome moly steel; quenched and tempered; upset forged
- Safety Factor: 5 times Working Load Limit = Minimum Breaking Strength
- Finish: Galvanized
- Standard: U.S. Federal Specification RR-C-271
- Shackles are supplied with Dock-regulations test certificate.

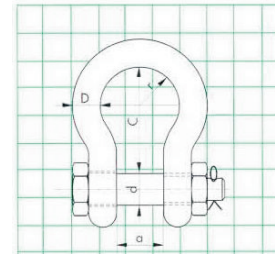

Never Exceed Working Load Limit

VAN BEEST WIDE JAW TOWING SHACKLES

Working Load Limit	Diameter Bow	Diameter Pin	Inside Width	Inside Length	Width of Bow	Approx. Wt.
				Anchor Type		
	D	d	a	c	2r	in lbs.
tons	inch	inch	inch	inch	inch	
16	1 1/2	1 5/8	4 3/16	8 1/2	6 1/4	27.55
25	1 3/4	2	5	9 3/4	6 7/8	39.68
30	2	2 1/4	5 3/4	10 3/4	8 5/32	55.12
55	2 1/2	2 3/4	6 1/2	12 3/8	8 3/8	105.82
75	3	3 1/4	7 1/4	13	10	209

- Material: Chrome moly alloy steel; quenched and tempered; upset forged
- Safety Factor: 4 times Working Load Limit = Minimum Breaking Strength
- Finish: Galvanized

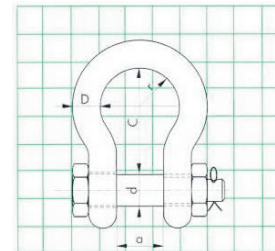

Never Exceed Working Load Limit



VAN BEEST SLING SAVER SHACKLES



Working Load Limit	Diameter Body	Diameter Pin	Inside Width	Width of Bow	Bearing Surface	Approx. Wt.
	D	d	a	2r	E	
tons	inch	inch	inch	inch	inch	lbs.
75	2.52	2.76	4.13	7.32	4.72	147.4
125	2.99	3.15	5.12	8.66	5.91	242
150	3.50	3.74	5.51	9.84	6.69	352
200	4.02	4.13	5.91	10.87	8.07	484
250	4.33	4.76	6.69	11.81	9.45	704
300	5.12	5.28	7.28	13.78	10.43	770
400	5.91	6.30	8.66	14.57	12.60	1397
500	6.69	7.09	9.84	17.72	13.39	1766
600	7.48	7.87	10.83	19.45	14.57	2156
700	8.27	8.46	11.81	21.26	15.75	2772
800	8.66	9.06	12.80	21.81	16.54	3146
900	9.45	9.84	13.78	22.99	17.32	3630
1000	10.24	10.63	14.96	24.17	18.11	4664
1200	10.63	11.81	16.93	25.35	20.87	5280



- Material: Alloy steel; quenched and tempered
- Safety Factor: 5 times Working Load Limit = Minimum Breaking Strength
- Finish: Body aluminum painted. Pin painted green.
- Proof load test certificate: Standard Lloyd's Register of Shipping. Material certificate DIN 50049-3.1.b.
- Forging tolerances: On inside width and length 5%.

Never Exceed Working Load Limit

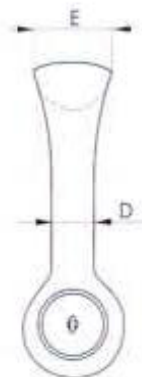
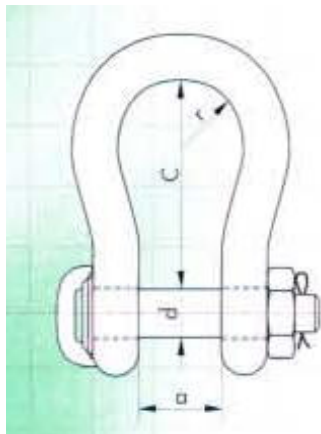



SCREW PIN ANCHOR SHACKLES - IMPORTED

Never Exceed Working Load Limit

HALO

Size (A)	Working Load Limit in Tons	Pin Diam. in Inches (B)	Approx. Weight Ea. in Lbs.	Dimensions in Inches			
				C	D	E	F
3/16 in.	0.33	0.25	0.05	0.88	0.38	0.56	0.63
1/4 in.	0.50	0.31	0.13	1.06	0.47	0.66	0.75
5/16 in.	0.75	0.38	0.21	1.25	0.53	0.81	0.84
3/8 in.	1.00	0.44	0.33	1.44	0.63	0.97	1
7/16 in.	1.50	0.50	0.47	1.69	0.75	1.06	1.13
1/2 in.	2.00	0.63	0.76	1.88	0.81	1.31	1.25
5/8 in.	3.25	0.75	1.44	2.44	1.06	1.56	1.69
3/4 in.	4.75	0.88	2.3	2.88	1.19	1.88	1.94
7/8 in.	6.50	1.00	3.5	3.38	1.44	2.13	2.19
1 in.	8.50	1.13	5	3.81	1.69	2.38	2.63
1 1/8 in.	9.50	1.25	7	4.25	1.75	2.63	2.88
1 1/4 in.	12.00	1.38	9.5	4.69	2	3	3.13
1 3/8 in.	13.50	1.50	13	5.31	2.13	3.25	3.5
1 1/2 in.	17.00	1.63	16.5	5.69	2.31	3.5	3.75
1 3/4 in.	25.00	2.00	29	7.06	2.88	4.25	4.88
2 in.	35.00	2.25	43	7.75	3.31	4.88	5.44
2 1/4 in.	45.00	2.50	59.4	9.25	3.63	5.25	5.5
2 1/2 in.	55.00	2.75	86	10.75	4.13	5.88	7.25
3 in.	85.00	3.25	119.5	13.75	4.88	6.75	7.63

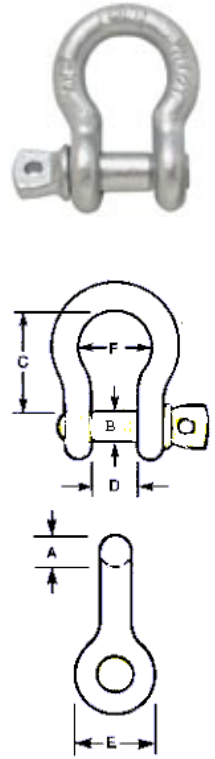

Do not use screw pin shackles if the pin can roll under load and unscrew.

BOLT TYPE SAFETY ANCHOR SHACKLES - IMPORTED

Never Exceed Working Load Limit

Size (A)	Working Load Limit in Tons	Bolt Diam. in Inches (B)	Approx. Weight Ea. in Lbs.	Dimensions in Inches			
				C	D	E	F
1/2 in.	2.00	0.63	0.9	1.88	0.81	1.31	1.25
5/8 in.	3.25	0.75	1.6	2.44	1.06	1.56	1.69
3/4 in.	4.75	0.88	2.8	2.88	1.19	1.88	1.94
7/8 in.	6.50	1.00	4.2	3.38	1.44	2.13	2.19
1 in.	8.50	1.13	6.4	3.81	1.69	2.38	2.63
1 1/8 in.	9.50	1.25	8.3	4.25	1.75	2.63	2.88
1 1/4 in.	12.00	1.38	11.7	4.69	2	3	3.13
1 3/8 in.	13.50	1.50	15.6	5.31	2.13	3.25	3.5
1 1/2 in.	17.00	1.63	19.7	5.69	2.31	3.5	3.75
1 3/4 in.	25.00	2.00	32.6	7.06	2.88	4.25	4.88
2 in.	35.00	2.25	48.3	7.75	3.31	4.88	5.44
2 1/4 in.	45.00	2.50	67	9.25	3.63	5.25	5.5
2 1/2 in.	55.00	2.75	94	10.75	4.13	5.88	7.25
3 in.	85.00	3.25	145	13.75	4.88	6.75	7.63

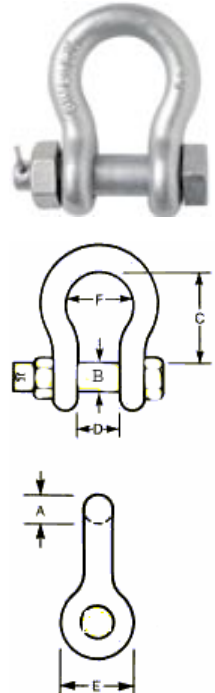



SCREW PIN CHAIN SHACKLES - IMPORTED

 Never Exceed Working Load Limit

HALO

Size (A)	Working Load Limit in Tons	Pin Diam. in Inches (B)	Approx. Weight Each in Pounds	Dimensions in Inches		
				C	D	E
1/4 in.	1/2	5/16	0.09	0.88	0.5	0.63
5/16 in.	3/4	3/8	0.17	1	0.53	0.78
3/8 in.	1	7/16	0.32	1.28	0.69	0.97
1/2 in.	2	5/8	0.8	1.72	0.84	1.28
5/8 in.	3 1/4	3/4	1.3	2.03	1.06	1.5
3/4 in.	4 3/4	7/8	2.2	2.41	1.25	1.81
7/8 in.	6 1/2	1	3.2	2.91	1.72	2.13
1 in.	8 1/2	1 1/8	5.1	3.25	1.75	2.38
1 1/8 in.	9 1/2	1 1/4	6.5	3.56	1.81	2.63
1 1/4 in.	12	1 3/8	9	3.97	2	2.91
1 3/8 in.	13 1/2	1 1/2	12.2	4.56	2.19	3.25
1 1/2 in.	17	1 5/8	17	5	2.34	3.5
1 3/4 in.	25	2	25.5	6	2.88	4.38
2 in.	35	2 1/4	37	7	3.31	4.91
2 1/2 in.	55	2 3/4	75	8	4.13	5.88
3 in.	85	3 1/4	108	8.25	5.25	6.75

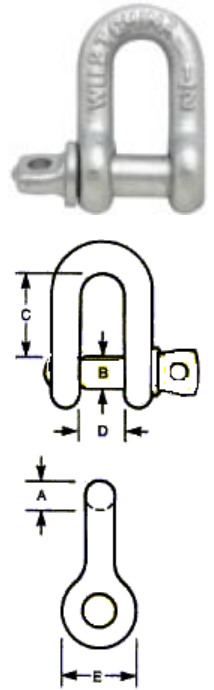

Do not use screw pin shackles if the pin can roll under load and unscrew.



SCREW PIN ANCHOR SHACKLES - TYPE 316 SS

Precision cast. Load rated. Meets Fed. Spec. RR-C-271D, Type IV, Class 2.

HALO

 Never Exceed Working Load Limit

Size (A)	B	C	D	W.L.L. (lbs.)	Wt. Ea. (lbs.)
3/16"	1/4"	3/8"	7/8"	650	0.04
1/4"	5/16"	15/32"	1-1/16"	1000	0.1
5/16"	3/8"	1/2"	1-1/4"	1500	0.18
3/8"	1/2"	5/8"	1-7/16"	2000	0.28
1/2"	5/8"	7/8"	1-7/8"	4000	0.68
5/8"	3/4"	1-1/16"	2-5/16"	6000	1.26
3/4"	7/8"	1-3/16"	2-7/8"	8000	2.1
7/8"	1"	1-1/2"	3-7/16"	10000	3.3
1"	1-1/8"	1-5/8"	3-3/4"	12000	4.6

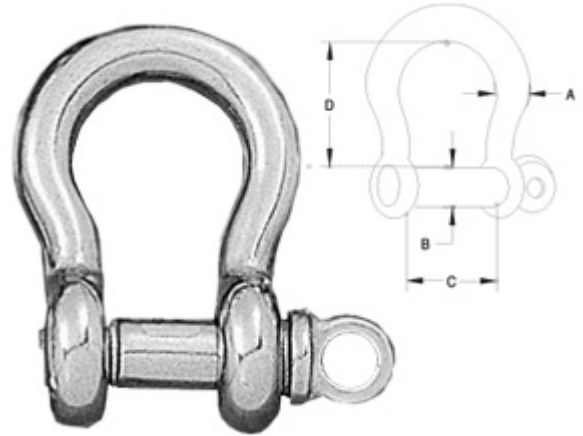

Do not use screw pin shackles if the pin can roll under load and unscrew.

SAFETY ANCHOR SHACKLES - TYPE 316 SS

Precision cast. Load rated. Meets Fed. Spec. RR-C-271D, Type IV, Class 3.

 Never Exceed Working Load Limit

Size (A)	B	C	D	W.L.L. (lbs.)	Wt. Ea. (lbs.)
1/4"	5/16"	15/32"	1-1/16"	1000	0.12
5/16"	3/8"	1/2"	1-1/4"	1500	0.2
3/8"	1/2"	5/8"	1-7/16"	2000	0.3
1/2"	5/8"	7/8"	1-7/8"	4000	0.7
5/8"	3/4"	1-1/16"	2-5/16"	6000	1.3
3/4"	7/8"	1-3/16"	2-7/8"	8000	2.3
7/8"	1"	1-1/2"	3-7/16"	10000	3.4
1"	1-1/8"	1-5/8"	3-3/4"	12000	4.8

