

**CM Cradle Grab hook—
100% proof tested**

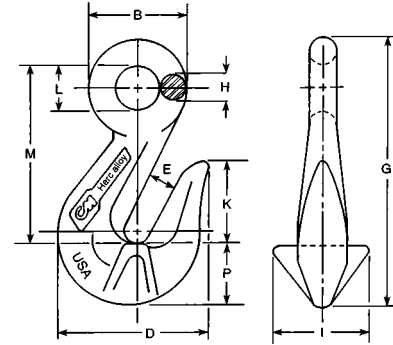

Chain size (in.) (mm)	Working load limit (lbs.)*	Product code	UPC 43927-	Dimensions (inches)											Weight each (lbs.)
				B	D	E	G	H	I	K	L	M	P		
7/32	5.5	2,100	559318	45060	1.19	1.75	.36	2.69	.38	1.19	.96	.63	1.63	.70	.35
9/32	7	3,500	559325	44959	1.38	1.81	.36	3.44	.38	1.19	.99	.63	2.36	.70	.40
3/8	10	7,100	559337	44922	1.78	2.63	.45	4.67	.50	1.75	1.48	.78	3.11	1.06	1.06
1/2	13	12,000	559350	45265	2.28	3.34	.59	5.86	.63	1.88	1.98	1.03	3.94	1.30	2.26
5/8	16	18,100	559362	44917	2.75	4.08	.75	7.13	.75	2.25	2.63	1.25	4.78	1.59	4.36
3/4	20	28,300	559575	45063	3.19	5.23	.88	8.99	.88	2.88	3.50	1.44	6.25	1.88	8.82
7/8	22	34,200	559387	42060	3.75	5.69	1.00	9.63	1.00	3.00	3.75	1.75	6.50	2.12	10.40
1	26	47,700	559100	44989	4.31	7.00	1.19	12.44	1.22	3.88	4.31	1.88	8.09	3.12	20.90
1 1/4†	32	72,300	559124	42052	5.38	8.50	1.50	15.56	1.56	3.50	5.50	2.25	10.50	3.50	40.00

†Not cradle type

CM sling hook without latch—
100% proof tested**

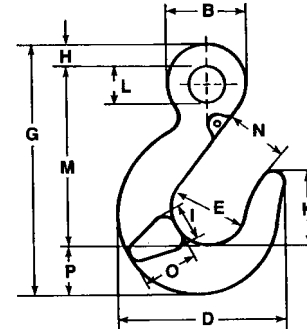

Chain size (in.) (mm)	Working load limit (lbs.)*	Product code	UPC 43927-	Dimensions (inches)												Weight each (lbs.)	
				B	D	E	G	H	I	K	L	M	N	O	P		
7/32	5.5	2,100	458544	42023	—	3.31	1.44	4.30	.38	.78	1.25	.75	3.06	1.25	1.00	.86	.7
9/32	7	3,500	458722	42000	1.62	3.50	1.50	5.25	.44	.73	1.59	.75	3.75	1.19	1.20	1.05	1.1
3/8	10	7,100	458725	44887	2.06	4.34	1.88	6.64	.56	.95	2.19	.94	4.78	1.44	1.45	1.28	1.9
1/2	13	12,000	458728	45259	2.63	5.50	2.25	8.16	.75	1.17	2.56	1.13	5.69	1.78	1.94	1.66	4.5
5/8	16	18,100	458729	44951	3.06	6.34	2.63	9.66	.88	1.44	2.63	1.31	6.50	2.03	2.38	2.19	7.3
3/4	20	28,300	458730	44992	3.50	7.83	3.00	11.38	1.00	1.69	3.44	1.50	7.81	2.50	2.83	2.51	11.4
7/8	22	34,200	458732	44994	3.88	8.59	3.38	12.72	1.09	1.94	3.88	1.69	8.75	2.78	3.22	2.84	18.1
1	26	47,700	458733	45079	4.31	9.59	4.00	14.23	1.22	2.14	4.25	1.88	9.88	3.13	3.55	3.09	22.6
1 1/4	32	72,300	458735	45103	5.31	11.56	4.66	17.00	1.50	2.62	4.64	2.31	11.50	3.88	4.25	3.89	36.0

**Available from stock with/without latch. Replacement latch kits are also available, see page 27. User must determine if latch is required on the hook.

**CM sling hook with latch—
100% proof tested**

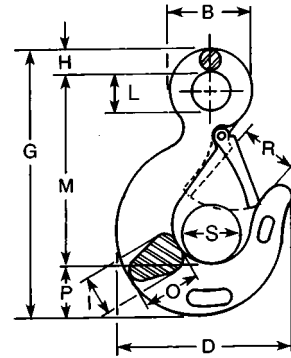

Chain size (in.) (mm)	Working load limit (lbs.)*	Product code	UPC 43927-	Dimensions (inches)												Weight each (lbs.)
				B	D	G	H	I	L	M	O	P	R	S		
7/32	5.5	2,100	558544	42031	—	3.31	4.30	.38	.78	.75	3.06	1.00	.86	1.11	1.11	.7
9/32	7	3,500	558322	44929	1.63	3.50	5.25	.44	.73	.75	3.75	1.20	1.05	1.06	1.06	1.1
3/8	10	7,100	558325	44888	2.06	4.34	6.64	.56	.95	.94	4.78	1.45	1.28	1.31	1.31	1.9
1/2	13	12,000	558328	45261	2.63	5.50	8.16	.75	1.17	1.13	5.69	1.94	1.66	1.56	1.63	4.5
5/8	16	18,100	558329	44974	3.06	6.34	9.66	.88	1.44	1.31	6.50	2.38	2.19	1.75	1.75	7.3
3/4	20	28,300	558330	44993	3.50	7.83	11.38	1.00	1.69	1.50	7.81	2.83	2.51	2.19	2.19	11.4
7/8	22	34,200	558332	44995	3.88	8.59	12.72	1.09	1.94	1.69	8.75	3.22	2.84	2.38	2.38	18.1
1	26	47,700	558333	45080	4.31	9.59	14.23	1.22	2.14	1.88	9.88	3.55	3.09	2.78	2.88	22.6
1 1/4	32	72,300	558335	45104	5.31	11.28	17.00	1.50	2.62	2.31	11.50	4.25	3.89	3.41	3.41	36.0

**CM foundry hook—
100% proof tested**

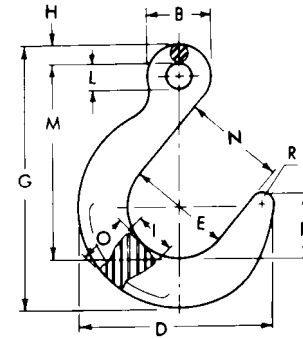

Chain size (in.) (mm)	Working load limit (lbs.)*	Product code	UPC 43927-	Dimensions (inches)												Weight each (lbs.)	
				B	D	E	G	H	I	K	L	M	N	O	R		
9/32	7	3,500	474498	42073	1.56	4.75	2.50	6.45	.47	1.00	1.56	.63	4.75	2.50	1.23	.25	2.4
3/8	10	7,100	474499	42074	2.00	5.75	3.00	7.88	.63	1.27	1.88	.75	5.75	3.00	1.50	.31	4.5
1/2	13	12,000	474500	42075	2.50	6.75	3.50	9.38	.75	1.50	2.22	1.00	6.88	3.50	1.75	.37	7.1
5/8	16	18,100	474501	42076	3.00	7.81	4.00	10.97	.88	1.81	2.63	1.25	8.06	4.00	2.03	.43	11.6
3/4	20	28,300	474502	42077	3.50	9.13	4.50	12.81	1.00	2.20	3.00	1.50	9.25	4.50	2.56	.50	20.0
7/8	22	34,200	474503	42078	4.00	10.14	5.00	14.23	1.13	2.25	3.38	1.75	10.38	5.00	2.78	.56	26.0
1	26	47,700	474504	42079	4.50	11.13	5.50	15.84	1.25	2.59	3.75	2.13	11.56	5.50	3.03	.62	36.8
1 1/4	32	72,300	474505	42080	5.13	12.84	6.00	18.03	1.38	3.17	4.25	2.38	12.88	6.00	3.81	.75	58.4

***▲WARNING**

- Do not exceed working load limit.
- Use only alloy chain and attachments for overhead lifting.

CM Large Eye Latchlok hook— proof tested

- For simplified rigging and secure load attachment.
- Recessed push button thumb release will not open accidentally, even if chain slacks; eliminates danger of an open hook snagging on a projection.
- Large Eye accepts wire rope thimbles.

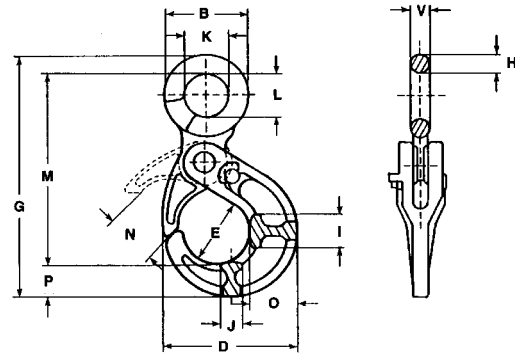

Chain size (in.) (mm)	Working load limit (lbs.)*	Product code	UPC 43927-	Dimensions (inches)																Weight each (lbs.)
				B	D	E	G	H	I	J	K	L	M	N	O	P	V			
9/32	7	3,500	674514	60005	2 3/16	3 7/16	1 3/8	6 11/16	1/2	1 5/16	1 3/16	1 3/16	1 3/16	5 3/16	1 3/8	1 5/16	1	1/2	1.28	
3/8	10	7,100	674518	60006	2 13/16	4 1/16	1 3/4	8 11/32	1 1/16	1 1/8	5/8	1 7/16	1 7/16	6 1/2	1 3/4	1 19/32	1 9/64	1 1/16	2.08	
1/2	13	12,000	674524	60007	3 5/8	4 3/4	2 1/4	10 9/16	7/8	1 11/16	1 3/8	1 7/8	1 7/8	8 9/32	2 3/16	1 21/32	1 3/8	7/8	4.12	
5/8-3/4	16/20	28,300	674530	60008	5 1/16	5 3/4	2 7/16	13 1/2	1 1/4	2 1/16	1 3/4	2 9/16	2 9/16	10 1/2	2 5/8	2 3/8	1 3/4	1 1/4	10.34	

CM Clevlok Latchlok hook— proof tested

- Alloy steel, forged & heat treated
- Rated for grade 80 Herc-Alloy chain
- Join directly to chain. No need for coupling links
- Recessed push button release. Will not open accidentally, even when chain goes slack
- Smooth contour prevents hooks snagging

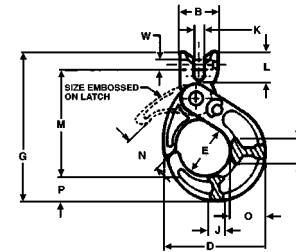

Chain size (in.)	Working load limit (lbs.)*	Product code	UPC 43927-	Dimensions (inches)														Weight each (lbs.)
				B	D	E	G	I	J	K	L	M	N	O	P	W		
9/32	3,500	674370	60000	1 23/64	3 7/16	1 5/8	5 9/32	1 5/16	1 3/16	2 1/64	1	3 49/64	1 3/8	1 15/16	1	3/8	1.5	
3/8	7,100	674372	60001	1 13/16	4 1/16	1 5/8	6 3/4	1 1/8	5/8	2 9/64	1 27/64	4 51/64	1 3/4	1 19/32	1 9/64	1 7/32	2.6	
1/2	12,000	674374	60002	2 3/16	4 3/4	2 1/16	8 9/16	1 11/16	1 3/8	5/8	1 43/64	6 5/64	2 3/16	2 21/32	1 3/8	2 1/32	5.7	
5/8	18,100	674379	60003	2 3/4	5 3/4	2 1/4	10 15/32	2 1/16	1 3/4	3/4	2 1/8	7 25/64	2 5/8	2 3/8	1 3/4	7/8	11.1	
3/4	28,300	674384	60004	3 1/8	5 3/4	2 1/4	10 7/8	2 1/16	1 3/4	7/8	2 19/32	7 7/16	2 5/8	2 3/8	1 3/4	1 1/16	11.7	

CM Clevlok Cradle Grab hook— 100% proof tested

Combines CM's unique Cradle Grab design with a simple, dependable clevis device for do-it-yourself hook attachment. Replacement load pins and retainer pins available.

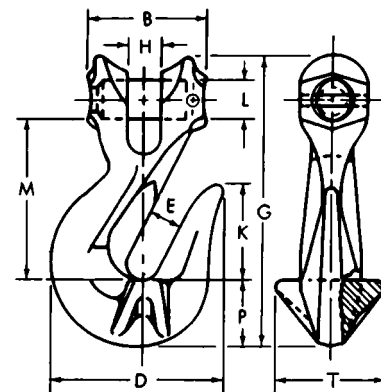

Chain size (in.) (mm)	Working load limit (lbs.)*	Product code	UPC 43927-	Dimensions (inches)												Weight each (lbs.)
				B	D	E		G	H	K	L Pin Dia.	M	P	T		
9/32	7	659222	42108	1.250	1.781	.359	±.016	3.000	.328	.984	.357	1.625	.718	1.187	.46	
3/8	10	659225	42111	1.812	2.562	.468	±.031	4.078	.453	1.406	.507	2.109	1.062	1.750	1.23	
1/2	13	659228	42114	2.156	3.250	.594	±.031	5.266	.593	1.875	.625	2.875	1.281	2.125	2.40	
5/8	16	659229	42117	2.687	4.078	.750	±.031	6.531	.750	2.375	.750	3.562	1.593	2.500	4.17	
3/4	20	659430	42120	3.125	5.234	.875	±.031	9.083	.875	3.503	.906	5.500	1.867	2.875	9.56	

CM Clevlok sling hook without latch—
100% proof tested**

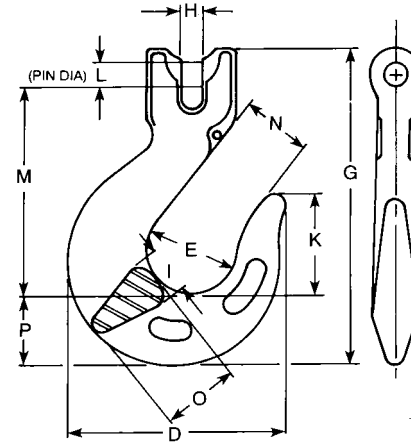

Chain size (in.) (mm)	Working load limit (lbs.)*	Product code	UPC 43927-	Dimensions (inches)												Weight each (lbs.)
				D	E	G	H	I	K	L	M	N	O	P		
9/32 7	3,500	658338	45077	3.500	1.500	5.156	.328	.734	1.594	.357	3.437	1.187	1.203	1.051	.64	
3/8 10	7,100	658339	45100	4.343	1.875	6.672	.453	.953	2.187	.507	4.468	1.437	1.453	1.281	1.91	
1/2 13	12,000	658340	45070	5.500	2.250	8.000	.593	1.172	2.562	.625	5.265	1.781	1.938	1.656	4.33	
5/8 16	18,100	658341	45147	6.281	2.625	9.687	.750	1.438	2.281	.750	6.078	2.031	2.375	2.188	5.20	
3/4 20	28,300	658342	45177	7.827	3.000	11.688	.875	1.688	3.437	.906	7.344	2.500	2.828	2.563	11.40	

**Latches available either as an option or in kit form. See below and page 27. User must determine whether latch is required on the hook. Replacement load pins and retainer pins available.

**CM Clevlok sling hook with latch—
100% proof tested**

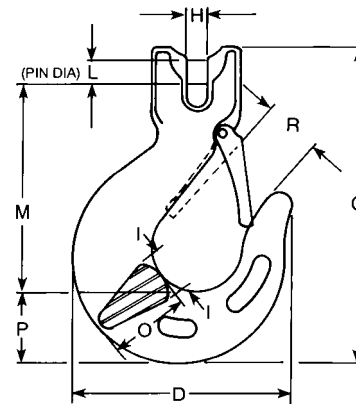

Chain size (in.) (mm)	Working load limit (lbs.)*	Product code	UPC 43927-	Dimensions (inches)										Weight each (lbs.)
				D	G	H	I	L	M	O	P	R		
9/32 7	3,500	658318	45078	3.500	5.156	.328	.734	.357	3.437	1.203	1.051	1.062	.80	
3/8 10	7,100	658319	45101	4.343	6.672	.453	.953	.507	4.468	1.453	1.281	1.312	2.03	
1/2 13	12,000	658320	45071	5.500	8.000	.593	1.172	.625	5.265	1.938	1.656	1.562	4.50	
5/8 16	18,100	658321	45148	6.281	9.687	.750	1.438	.750	6.078	2.375	2.188	1.750	6.50	
3/4 20	28,300	658322	45178	7.827	11.688	.875	1.688	.906	7.344	2.828	2.563	2.187	11.80	

Replacement load pins and retainer pins available.

*** ⚠ WARNING**

- Do not exceed working load limit.
- Use only alloy chain and attachments for overhead lifting.

CM hook latch kits

Kit includes all hardware for easy installation on CM eye and Clevlok sling hooks.

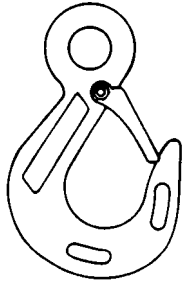

Current Style Latch

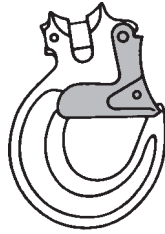

Old Style Latch

Chain size (in.)	Current style latch		Old style latch	
	Product code	UPC 43927-	Product code	UPC 43927-
7/32	—	—	595461	42087
9/32	595523	44919	595461	42087
3/8	595525	45260	595463	42088
1/2	595528	35990	595474	42095
5/8	595529	44975	595465	42090
3/4	595530	44984	595466	42091
7/8	595532	45081	595467	42092
1	595533	45082	595468	42093
1 1/4	595535	44988	595469	42094

CM S hook—proof tested

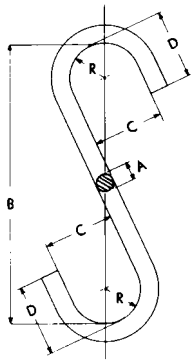

Size A (in.)	Working load limit (lbs.)*	Product code	UPC 43927-	Dimensions (inches)				Weight each (lbs.)
				B	C	D	R	
9/32	210	562228	23690	4 1/2	1 1/8	1 1/8	9/16	.15
3/8	410	562237	23691	6	1 1/2	1 1/2	3/4	.35
1/2	870	562250	23692	7 1/2	2	2	1	.82
5/8	1,120	562262	23693	9	2 1/2	2 1/2	1 1/4	1.6
3/4	1,730	562275	23694	10 1/2	3	3	1 1/2	2.6
7/8	2,370	562287	23695	12	3 1/2	3 1/2	1 3/4	4.2
1	2,920	562300	23696	13	4	4	2	6.0
1 5/32	3,150	562310	23697	15	4 1/2	4 1/2	2 1/4	9.3
1 1/4	4,450	562325	23698	16	5	5	2 1/2	11.7
1 3/8	6,100	562337	23699	17	5 1/2	5 1/2	2 3/4	15.4
1 1/2	6,250	562350	23700	18	6	6	3	19.5

CM plate hook—proof tested

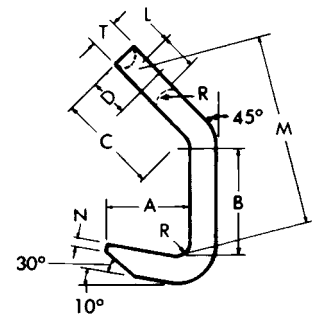

Chain size (in.)	Working load limit (lbs.)*	Product code	UPC 43927-	Dimensions (inches)										Weight each (lbs.)
				A	B	C	D	L	M	N	T	R	W	
9/32	3,600	462528	23675	2	1 3/4	2 1/2	15/16	1	3 11/16	1/8	5/8	5/16	2 1/2	2.8
3/8	7,050	462537	23676	2 5/8	3	4 5/16	13/16	1 1/8	6 3/8	3/16	3/4	3/8	2 3/4	5.7
1/2	11,400	462550	23677	3 1/2	4	4 3/8	1 1/2	1 1/2	7 3/8	1/4	1	1/2	3 1/2	13.0
5/8	17,800	462562	23678	4 3/8	5	5 7/16	1 7/8	1 7/8	9 1/4	5/16	1 1/4	5/8	5	26.5
3/4	25,600	462575	23679	5 3/16	6	6 1/2	2 3/8	2 1/4	10 7/8	3/8	1 1/2	3/4	5 3/4	42.0
7/8	34,900	462587	23680	6	7	7 5/8	2 1/2	2 5/8	13 1/16	7/16	1 3/4	1	6	65.0

NOTE: For mechanical assembled slings, next larger size Hammerlok coupling link is required in addition to regular size Hammerlok coupling link.

CM oblong master link—proof tested

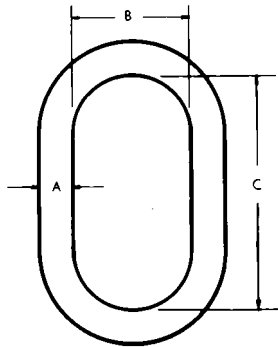

Link no.	Product code	UPC 43927-	Working load limit (lbs.)*†	Link size (inches)			Type & size of chain sling on which used				Weight each (lbs.)
				Diameter material A	Inside width B	Inside length C	Single type S & C	Double type D	Triple type T	Quad type Q	
HA40	554931	23327	3,600	13/32	1 1/2	3	7/32	7/32	—	—	.33
HA50	554932	23328	6,100	1/2	2 1/2	5	9/32	9/32	7/32	7/32	.8
HA75	554935	23329	12,300	3/4	2 3/4	5 1/2	3/8	3/8	9/32	9/32	2.1
HA100	554938	23330	20,800	1	3 1/2	7	1/2 or 5/8	1/2	3/8	3/8	4.6
HA125	554940	23331	31,300	1 1/4	4 3/8	8 3/4	3/4	5/8	1/2	1/2	9.2
HA150	554943	23333	49,000	1 1/2	5 1/4	10 1/2	7/8	3/4	5/8	5/8	15.7
HA175	554946	23335	73,500	1 3/4	6	12	1	7/8	3/4	3/4	24.5
HA200	554949	23337	88,900	2	7	14	1 1/4	1	7/8	7/8	37.3
HA225	554951	23339	125,200	2 1/4	8	16	—	1 1/4	1	1	54.0
HA275	554957	23342	187,800	2 3/4	9	16	—	—	1 1/4	1 1/4	84.8

†Working load limit of master link only. For sling WLL see pages 14-22.

CM oblong master link—special sizes—proof tested

• Heat treated

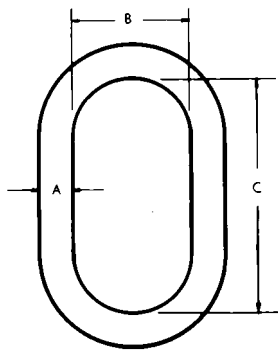

Diameter (in.)	Product code	UPC 43927-	Working load limit (lbs.)*†	Dimensions (inches)			Approx. weight each (lbs.)
				A	B	C	
1	554969	23345	18,200	1	4	8	5.3
1 1/4	554942	23332	22,800	1 1/4	6	12	12.1
1 1/2	554970	23346	42,900	1 1/2	6	12	17.6
1 1/2	554944	23334	36,700	1 1/2	7	14	20.1
1 3/4	554945	23359	63,000	1 3/4	7	14	27.9
2	554952	23340	77,800	2	8	16	41.9
2 1/2	554954	23341	147,300	2 1/2	8	16	67.0
3	554958	—	228,000	3	9	18	111.0
3 1/4	554959	—	262,200	3 1/4	10	20	144.0
3 1/2	554960	—	279,000	3 1/2	12	24	197.0

†Working load limit of master link only. For sling WLL see pages 14-22.

CM oblong master link sub-assembly—proof tested**

for triple and quad branch chain slings

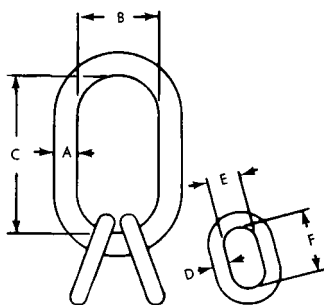

HA chain (in.)	Sub-assembly number	Product code	UPC 43927-	Oblong master link size (inches)			Master coupling link size (inches)			Weight (lbs.)
				A	B	C	D	E	F	
7/32	HA50-SA	554974	23575	1/2	2 1/2	5	11/32	5/8	1 1/8	1.0
9/32	HA75-SA	554975	23576	3/4	2 3/4	5 1/2	15/32	7/8	1 9/16	2.6
3/8	HA100-SA	554976	23577	1	3 1/2	7	21/32	1 1/4	2 1/4	6.1
1/2	HA125-SA	554977	23578	1 1/4	4 3/8	8 3/4	29/32	1 3/4	3 1/8	13.3
5/8	HA150-SA	554978	23579	1 1/2	5 1/4	10 1/2	15/32	2 1/4	4	24.3
3/4	HA175-SA	554979	23580	1 3/4	6	12	19/32	2 3/8	4 3/8	36.1
7/8	HA200-SA	554980	23581	2	7	14	117/32	2 3/4	5 1/4	57.4
1	HA225-SA	554981	23582	2 1/4	8	16	1 25/32	3	6	83.9
1 1/4	HA275-SA	554983	23583	2 3/4	9	16	2 1/32	3 1/2	7	129.7

**Consisting of oblong master link and two welded master coupling links.

***⚠ WARNING**

- Do not exceed working load limit.
- Use only alloy chain and attachments for overhead lifting.

CM master ring—proof tested

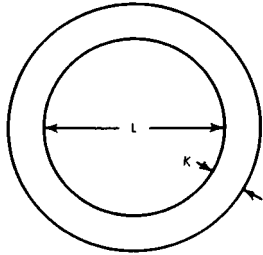

Product code	UPC 43927-	Working load limit (lbs.)*†	Ring size (inches)		Type & size of chain sling on which used				Weight each (lbs.)
			Diameter material K	Inside dia. of ring L	Single type S & C	Double type D	Triple type T	Quad type Q	
554611	23494	3,500	1/2	2 1/2	9/32	—	—	—	.5
554613	23495	6,100	5/8	3	—	9/32	—	—	1.0
554615	23496	9,100	3/4	4	3/8	—	9/32	9/32	1.8
554617	23497	12,300	7/8	4	—	3/8	—	—	2.6
554619	23499	18,400	1	4	1/2	—	3/8	3/8	3.4
554623	23502	20,800	1 1/4	5	5/8 or 3/4	1/2	—	—	6.9
554627	23504	31,300	1 1/2	6	7/8	5/8	1/2	1/2	11.7
554630	23506	49,000	1 3/4	7	1	3/4	5/8	5/8	18.6
554635	23509	73,500	2	8	—	7/8	3/4	3/4	27.9
554636	23510	88,900	2 1/4	9	1 1/4	1	7/8	7/8	39.9

†Working load limit of master link only. For sling WLL see pages 14-22.

CM pear-shaped master link—proof tested

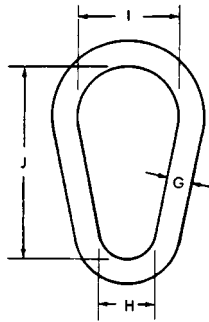

Link no.	Working load limit (lbs.)*†	Product code	UPC 43927-	Link size (inches)				Type & size of chain sling on which used		Weight each (lbs.)
				Diameter material G	Inside width H	Inside length J	Inside width I	Single type S&C	Double type D	
HA51	6,100	554702	23403	1/2	1 1/4	2 1/2	5 5/16	9/32	9/32	.8
HA79	12,300	554706	23405	3/4	2	2 3/4	5 5/8	3/8	3/8	2.1
HA103	20,800	554710	23408	1	2 5/8	3 1/2	7 1/4	1/2 or 5/8	1/2	4.6
HA129	31,300	554714	23410	1 1/4	3 1/4	4 5/8	8 3/4	3/4	5/8	9.2
HA153	49,000	554719	23413	1 1/2	3 7/8	5 1/4	10 1/2	7/8	3/4	15.3
HA179	59,200	554723	23414	1 3/4	4 1/2	6	12	1	7/8	23.9
HA201	82,600	554726	23415	2	3 1/2	7	14	1 1/4	1	35.9
HA229	125,200	554731	23416	2 1/4	6	8	16	—	1 1/4	52.8

†Working load limit of master link only. For sling WLL see pages 14-22.

CM welded coupling link—proof tested

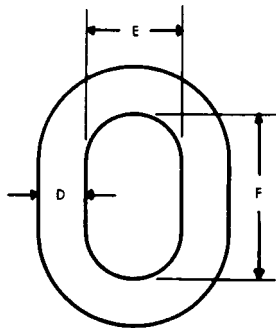

Chain size (in.)	Link size (inches)		
	Diameter material D	Inside width E	Inside length F
9/32	11/32	5/8	1 1/8
3/8	15/32	7/8	1 9/16
1/2	2 1/32	1 1/4	2 1/4
5/8	25/32	1 1/2	2 5/8
3/4	29/32	1 3/4	3 1/8
7/8	1 1/32	2	3 1/2
1	15/32	2 1/4	4
1 1/8**	19/32	2 3/8	4 3/8
1 1/4	1 17/32	2 3/4	5 1/4
1 1/2**	1 25/32	3	6
—	1 25/32	3 1/2	7
—	2 1/32	3 1/2	7

**Non-stock item.

CM grab link—proof tested

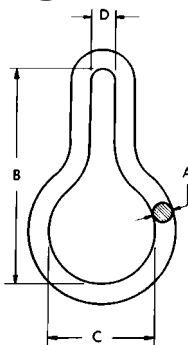

Chain size (in.)	Working load limit (lbs.)*	Product code	UPC 43927-	Link size (inches)				Weight each (lbs.)
				A	B	C	D	
9/32	3,500	554320	23782	1/2	5 1/2	2 1/2	37/64	.79
3/8	7,100	554326	23783	3/4	6 1/16	2 3/4	5/8	2.1
1/2	12,000	554332	23785	1	7 5/8	3 1/2	3/4	4.6
5/8	18,100	554337	23786	1 1/4	9 1/4	4 3/8	1	9.2
3/4	28,300	554342	23787	1 3/8	11 1/4	6	1 1/8	14.3
7/8	34,200	554347	20291	1 1/2	11 3/4	5 1/4	1 3/8	16.8
1	47,700	554352	23788	1 3/4	13 3/4	7	1 1/2	26.7
1 1/4	72,300	554362	20292	2 1/4	17 1/2	9	2 1/4	57.2

NOTE: Although CM can supply these types of master links and rings, the oblong link is recommended for general use.

CM Hammerlok coupling link—proof tested

Dependable and easy to use for fast assembly on the job, for attaching chain to master links and eye type hooks and for installing new body chain in old slings. C.V.S.A. approved.

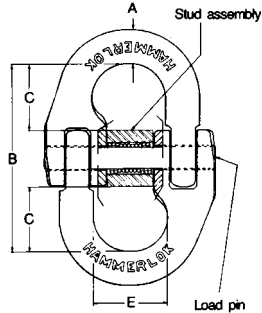

Chain size (in.)	Working load limit (lbs.)*	Product code	UPC 43927-	Dimensions (inches)					Max. width	Diameter hole to accept male leg	Weight each (lbs.)
				A	B	C	E†				
7/32	2,100	664220	23087	1/4	1 13/32	31/64	13/32	1 5/16	1/2	.12	
9/32	3,500	664228	23097	5/16	1 13/16	5/8	1/2	1 11/16	35/64	.23	
3/8	7,100	664241	23107	1/2	2 13/32	53/64	3/4	2 7/32	47/64	.65	
1/2	12,000	664250	23118	11/16	3 3/8	17/32	1	3 1/8	59/64	1.5	
5/8	18,100	664262	23130	13/16	4 1/16	1 1/2	1 1/4	3 11/16	1 1/16	2.6	
3/4	28,300	664275	23142	15/16	4 25/32	1 51/64	1 1/2	4 5/16	1 1/4	3.8	
7/8	34,200	664287	23152	1 3/64	5 1/8	1 29/32	1 3/4	5 5/16	1 11/32	6.3	
1	47,700	664300	23163	1 1/4	5 3/4	2 3/16	2	6 3/16	1 9/16	9.3	
1 1/4	72,300	664325	23173	1 17/32	6 13/16	2 5/8	2 1/4	7 3/4	2	17.3	

†Diameter of stock of largest master link intended to be used with Hammerlok.

CM chain shortener

Standard arrangement consists of five links of body chain, two coupling links and two grab hooks as illustrated.

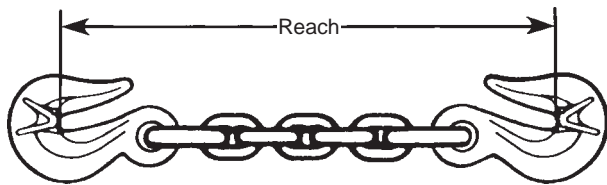

Chain size (in.)	Working load limit (lbs.)*	Product code	UPC 43927-	Reach (in.)
9/32	3,500	604261	32731	11 1/4
3/8	7,100	604262	32741	15 3/8
1/2	12,000	604263	32746	19 3/8
5/8	18,100	604264	32751	23 3/8
3/4	28,300	604265	32756	28
7/8	34,200	604266	32761	33 1/4
1	47,700	604267	32766	37 1/2
1 1/4	72,300	604268	32771	47 3/4

CM identification/serial number tag

- OSHA required
- Zinc plated
- Suitable for all sizes of slings

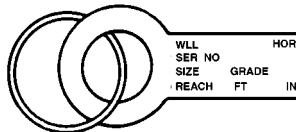
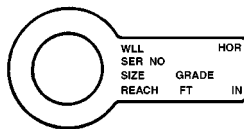

Description	Product code	UPC 43927-
Without ring	457106	24188
With 2" Key ring	557193	35979

*** ⚠ WARNING**

- Do not exceed working load limit.
- Use only alloy chain and attachments for overhead lifting.

CM high test clevis type chain hook

- Attach directly to welded chain—no connecting links to buy.
- Heat treated pins.
- Extra deep throat.
- Made for use on all high test chain (grade 43) and proof coil (grade 30).
- Hooks have a clear protective finish to resist rust and for cleaner handling.
- Hooks available with bright zinc finish.
- “High test” forged on every hook.
- Carbon hooks have clear dip bodies with orange pins.

Dixie clevis grab hook—grade 30

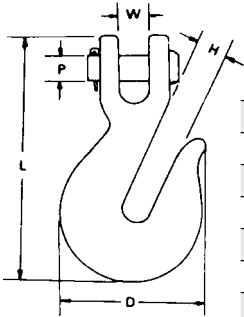

Hook size (in.)	Working load limit (lbs.)*	Clear finish industrial pack		Zinc plated industrial pack		Pack	Dimensions (inches)					Approx. weight each (lbs.)
		Product code	UPC 81767-	Product code	UPC 81767-		W	P	H	L	D	
1/4	1,300	61190	61190	—	—	50	5/16	5/16	11/32	2 29/32	1 13/16	.37
1/4	1,300	—	—	61191	61191	50	5/16	5/16	11/32	2 29/32	1 13/16	.37
1/4	1,300	—	—	62191	62191	10	5/16	5/16	11/32	2 29/32	1 13/16	.37
5/16	1,900	61290	61290	—	—	50	25/64	3/8	27/64	3 17/32	2 7/64	.63
5/16	1,900	—	—	61291	61291	50	25/64	3/8	27/64	3 17/32	2 7/64	.63
5/16	1,900	—	—	62291	62291	10	25/64	3/8	27/64	3 17/32	2 7/64	.63
3/8	2,650	61390	61390	—	—	50	15/32	7/16	1/2	4 9/64	2 19/32	1.10
3/8	2,650	—	—	61391	61391	50	15/32	7/16	1/2	4 9/64	2 19/32	1.10
3/8	2,650	—	—	62391	62391	10	15/32	7/16	1/2	4 9/64	2 19/32	1.10
1/2	4,500	61590	61590	—	—	10	5/8	9/16	21/32	5 19/64	3 23/64	2.42
1/2	4,500	—	—	61591	61591	10	5/8	9/16	21/32	5 19/64	3 23/64	2.42

Dixie clevis slip hook—grade 30

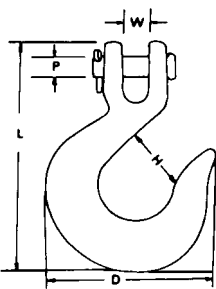

Hook size (in.)	Working load limit (lbs.)*	Clear finish industrial pack		Zinc plated industrial pack		Pack	Dimensions (inches)					Approx. weight each (lbs.)
		Product code	UPC 81767-	Product code	UPC 81767-		W	P	H	L	D	
1/4	1,300	66190	66190	—	—	25	.35	.31	.78	2.27	2.32	.35
1/4	1,300	—	—	66191	66191	25	.35	.31	.78	2.27	2.32	.35
1/4	1,300	—	—	67191	67191	10	.35	.31	.78	2.27	2.32	.35
5/16	1,900	66290	66290	—	—	25	.42	.38	.83	2.59	2.72	.63
5/16	1,900	—	—	66291	66291	25	.42	.38	.83	2.59	2.72	.63
5/16	1,900	—	—	67291	67291	10	.42	.38	.83	2.59	2.72	.63
3/8	2,650	66390	66390	—	—	25	.50	.44	.92	2.98	3.20	1.02
3/8	2,650	—	—	66391	66391	25	.50	.44	.92	2.98	3.20	1.02
3/8	2,650	—	—	67391	67391	10	.50	.44	.92	2.98	3.20	1.02
1/2	9,200	66590	66590	—	—	10	.65	.54	1.34	4.17	4.32	2.27
1/2	9,200	—	—	66591	66591	10	.65	.54	1.34	4.17	4.32	2.27

CM clevis grab hook—grade 43

Hot forged, heat treated and tempered

Hook size (in.)	Working load limit (lbs.)*	Clear finish industrial pack		Zinc plated industrial pack		Dimensions (inches)						Approx. weight each (lbs.)
		Product code	UPC 43927-	Product code	UPC 43927-	W	P	H	R	L	D	
1/4	2,600	M804L	41102	M804ZL	41105	5/16	5/16	3/8	2	33/8	115/16	.38
5/16	3,900	M805L	41118	M805ZL	41121	3/8	3/8	7/16	2 3/8	329/32	21/4	.62
3/8	5,400	M806L	41134	M806ZL	41137	7/16	7/16	1/2	2 11/16	4 1/2	2 11/16	.96
7/16	7,200	M807L	41149	M807ZL	41152	1/2	1/2	9/16	3	5 1/32	3	1.46
1/2	9,200	M808L	41162	M808ZL	41165	19/32	9/16	21/32	3 23/64	5 39/64	3 5/16	2.02
5/8	13,000	M810L	41173	M810ZL	41176	3/4	1 1/16	25/32	4	6 7/8	4 1/4	3.76
3/4	20,200	M812	37233	M812Z	38688	7/8	3/4	15/16	4 19/32	8	5 1/4	6.41

Applications: Designed for use with welded chain G30 or G43.
Description: Natural and zinc plated finish.

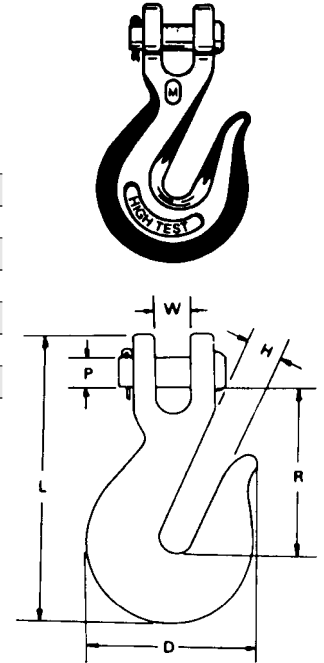

CM clevis slip hook—grade 43

Hot forged, heat treated and tempered

Hook size (in.)	Working load limit (lbs.)*	Clear finish industrial pack		Zinc plated industrial pack		Dimensions (inches)							Approx. weight each (lbs.)
		Product code	UPC 43927-	Product code	UPC 43927-	W	P	H	R	L	G	D	
1/4	2,600	M904L	41194	M904ZL	41197	5/16	5/16	15/16	2 5/16	3 11/16	13/16	2 5/8	.47
5/16	3,900	M905L	41206	M905ZL	41209	3/8	3/8	1 1/16	2 9/16	4 3/16	15/16	3 1/16	.73
3/8	5,400	M906L	41222	M906ZL	41225	7/16	7/16	1 1/4	3	4 7/8	1 1/8	3 1/2	1.16
7/16	7,200	M907L	41237	M907ZL	41240	1/2	1/2	1 9/16	3 1/2	5 11/16	1 3/8	4 15/16	1.95
1/2	9,200	M908L	41249	M908ZL	41252	19/32	9/16	1 3/4	3 15/16	6 3/8	1 1/2	4 7/8	2.55
5/8	13,000	M910	41259	M910Z	41261	3/4	1 1/16	2	4 3/4	7 9/16	1 11/16	5 11/16	4.24

Applications: Designed for use with welded chain G30 or G43.
Description: Natural and zinc plated finish.

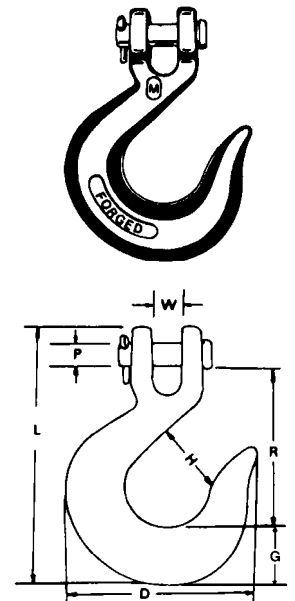

* ⚠ WARNING

Improper use or care of attachments can result in bodily injury or property damage.

To avoid injury or damage, always observe the following when using hooks:

- Use alloy attachments for overhead lifting.
- Do not exceed working load limit.
- Do not shock or impact load.
- Do not side load—center line of load must coincide with center line of attachment.
- Do not replace pin with other than original equipment parts.
- Inspect before use for wear, deformation and pin engagement.

CM clevis type grab hook—transport grade 70

For grade 70 transport chain

- Designed specifically for transport grade 70 chain.
- Popular 5/16" and 3/8" sizes.
- Working load limits that match grade 70 chain.
- Higher strength to weight ratios due to more massive design.
- Design ultimate strength equals 4 times working load limit.
- Yellow chromate finish.
- Hooks embossed with chain grade.

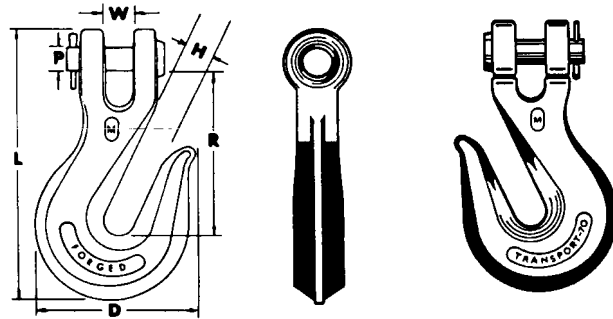

Chain size (in.)	Working load limit (lbs.)*	Product code	UPC 43927-	Dimensions (inches)						Approx. weight each (lbs.)
				W	D	H	L	P	R	
5/16	4,700	M805T	41337	.38	2.31	.44	4.0	.39	2.34	75
3/8	6,600	M806T	41344	.45	2.63	.50	4.50	.49	2.66	1.10

CM alloy clevis type chain hook

- Attach directly to the chain—no connecting links to buy.
- Heat treated pins.
- Extra deep throat.
- Painted orange.
- Hooks embossed with chain grade.
- "Alloy" forged on every hook.
- Grab hooks are compatible with grade 80 alloy chain except M807A.
- Slip hooks and M807A compatible with grade 63 alloy chain.
- Alloy clevis hooks develop the mechanical properties of grade 80 & 63 as stated, but are not recommended for overhead lifting sling applications.

CM alloy clevis type grab hook—grade 80

Hot forged, heat treated and tempered

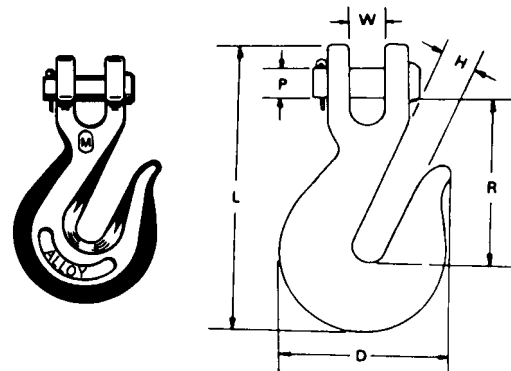

Chain size (in.)	Working load limit (lbs.)*†	Product code	UPC 43927-	Dimensions (inches)						Approx. weight each (lbs.)	Standard industrial pack
				W	D	H	L	P	R		
1/4	3,500	M804A	41268	5/16	1 15/16	3/8	3 1/4	2 1/64	1 7/8	.38	30
5/16	4,500	M805A	41274	3/8	2 9/32	7/16	3 31/32	25/64	2 3/8	.62	30
3/8	7,100	M806A	41281	29/64	2 5/8	1/2	4 1/2	1/2	2 5/8	.96	30
7/16	6,900	M807A**	41286	1/2	3	9/16	5 1/32	1/2	3	1.46	20
1/2	12,000	M808A	41290	19/32	3 7/16	2 1/32	5 23/32	19/32	3 5/16	2.02	10
5/8	18,100	M810A	41296	3/4	4 5/16	25/32	6 7/8	3/4	3 15/16	3.75	10

**Grade 63.

†Alloy clevis hooks develop the mechanical properties of grade 80 & 63 as stated, but are not recommended for overhead lifting sling applications.

*▲WARNING

Improper use or care of hooks can result in bodily injury or property damage.

To avoid injury or property damage, always observe the following when using hooks:

- Do not exceed working load limit.
- Use only alloy hooks for overhead lifting.
- Do not tip load or use in any manner for which the hook was not intended.
- Do not shock or dynamic load.
- Do not apply load to hook latches. Latches are to retain slack slings and chain only.

CM alloy clevis type slip hook—grade 63

Hot forged, heat treated and tempered

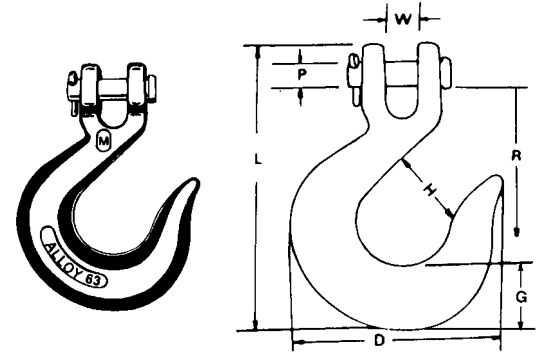

Chain size (in.)	Working load limit (lbs.)*†	Product code	UPC 43927-	Dimensions (inches)							Approx. weight each (lbs.)	Standard industrial pack
				W	D	H	L	P	R	G		
1/4	2,750	M904A	41301	5/16	2 5/8	15/16	3 11/16	11/32	2 5/16	13/16	.47	20
5/16	3,600	M905A	41308	3/8	3 1/16	1 1/16	4 3/16	25/64	2 9/16	15/16	.73	20
3/8	5,500	M906A	41314	15/32	3 1/2	1 1/4	4 7/8	1/2	3	1 1/8	1.16	20
7/16	6,900	M907A	41320	1/2	4 5/16	1 9/16	5 11/16	1/2	3 1/2	1 3/8	1.95	10
1/2	9,400	M908A	41325	19/32	4 7/8	1 3/4	6 3/8	19/32	3 15/16	1 1/2	2.55	10
5/8	14,200	M910A	41330	3/4	5 11/16	2	7 9/16	3/4	4 3/4	1 11/16	4.24	5

†Alloy clevis hooks develop the mechanical properties of grade 80 & 63 as stated, but are not recommended for overhead lifting sling applications.

CM eye type chain hook

- Use with Big Orange mid-link to connect directly to chain.
- Extra deep throat.
- Made for use on grade 43 high test chain and grade 30 proof coil chain.
- Hooks are supplied in grade 30 when no suffix is indicated.
- Hooks available with bright zinc finish.
- Hooks have a clear protective finish to resist rust and for cleaner handling.
- Bulk packaging is available on large quantities upon request, in both grade 30 and grade 43, without protective finish.
- Hooks embossed with chain grade.

CM eye type grab hook—grade 30

For use with grade 30 proof coil chain

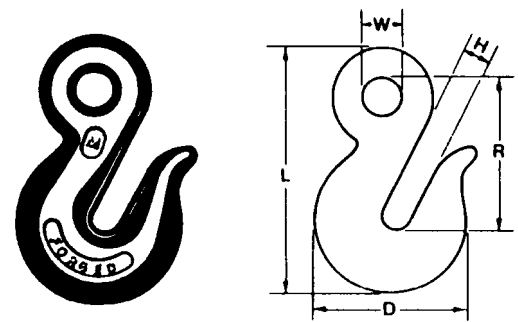

Chain size (in.)	Working load limit (lbs.)*	Clear finish		Zinc plated		Dimensions (inches)					Approx. weight each (lbs.)	Standard industrial pack
		Product code	UPC 43927-	Product code	UPC 43927-	W	D	H	L	R		
1/4	1,300	M204RL	41368	M204ZL	41371	17/32	2	3/8	3 3/64	1 15/16	.28	30
5/16	1,900	M205RL	41375	M205ZL	41378	5/8	2 11/32	7/16	3 5/8	2 3/8	.54	30
3/8	2,650	M206RL	41382	M206ZL	41385	25/32	2 11/16	1/2	4 9/32	2 13/16	.80	30
7/16	3,700	M207RL	41390	M207ZL	41393	13/16	3 3/64	37/64	4 55/64	3 11/64	1.32	20
1/2	4,500	M208RL	41398	M208ZL	41401	15/16	3 25/64	21/32	5 33/64	3 5/8	1.74	10
5/8	6,900	M210RL	41405	M210ZL	41408	1 1/16	4 5/16	25/32	6 15/16	4 33/64	3.44	10
3/4	10,600	M212R	41409	M212Z	41411	1 3/8	5 7/32	15/16	8 5/16	5 3/8	6.10	Bulk

CM eye type slip hook—grade 30

For use with grade 30 proof coil chain

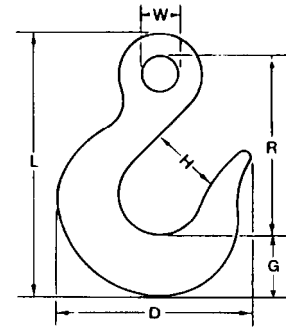

Chain size (in.)	Working load limit (lbs.)*	Clear finish		Zinc plated		Dimensions (inches)						Approx. weight each (lbs.)	Standard industrial pack
		Product code	UPC 43927-	Product code	UPC 43927-	W	D	H	L	R	G		
1/4	1,300	M304RL	41447	M304ZL	41450	17/32	2 9/16	15/16	3 19/32	2 15/32	13/16	.42	20
5/16	1,900	M305RL	41454	M305ZL	41457	5/8	3 1/16	1 1/16	4 3/32	2 25/32	15/16	.58	20
3/8	2,650	M306RL	41461	M306ZL	41464	25/32	3 1/2	1 1/4	4 27/32	3 5/16	1 1/8	1.00	20
7/16	3,700	M307RL	41468	M307ZL	41471	13/16	4 21/64	1 9/16	5 19/32	3 3/4	1 3/8	1.50	10
1/2	4,500	M308RL	41476	M308ZL	41479	15/16	4 29/32	1 3/4	6 11/32	4 5/16	1 1/2	2.50	10
5/8	6,900	M310R	41483	M310ZL	41485	1 3/16	5 5/8	2	7 3/4	5 5/16	2 1/4	3.70	5
3/4	10,600	D74792	34307	—	—	1 1/4	7 1/8	2 1/4	9	5 13/16	2 3/8	6.00	Bulk

CM heat treated eye type grab hook—grade 43

For use with grade 43 high test chain

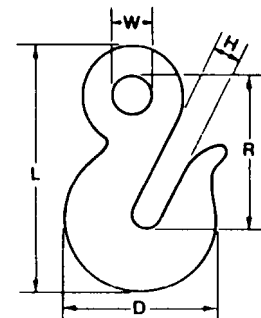

Chain size (in.)	Working load limit (lbs.)*	Clear finish		Zinc plated		Dimensions (inches)					Approx. weight each (lbs.)	Standard industrial pack
		Product code	UPC 43927-	Product code	UPC 43927-	W	D	H	L	R		
1/4	2,600	M204H	41414	M204HZ	41415	17/32	2	3/8	3 3/64	1 15/16	.28	30
5/16	3,900	M205H	41419	M205HZ	41420	5/8	2 11/32	7/16	3 5/8	2 3/8	.54	30
3/8	5,400	M206H	41424	M206HZ	41426	25/32	2 11/16	1/2	4 9/32	2 13/16	.80	30
7/16	7,200	M207H	41429	M207HZ	41430	13/16	3 3/64	37/64	4 55/64	3 11/64	1.32	20
1/2	9,200	M208H	41434	M208HZ	41435	15/16	3 25/64	21/32	5 33/64	3 5/8	1.74	10
5/8	13,000	M210H	41438	M210HZ	41439	1 1/16	4 5/16	25/32	6 15/16	4 33/64	3.44	10
3/4	20,200	M212H	41442	M212HZ	41443	1 3/8	5 7/32	15/16	8 5/16	5 3/8	6.10	Bulk

*▲WARNING

Improper use or care of hooks can result in bodily injury or property damage.

To avoid injury or property damage, always observe the following when using hooks:

- Do not exceed working load limit.
- Use only alloy hooks for overhead lifting.
- Do not tip load or use in any manner for which the hook was not intended.
- Do not shock or dynamic load.
- Do not apply load to hook latches. Latches are to retain slack slings and chain only.

CM heat treated eye type slip hook—grade 43

For use with grade 43 high test chain

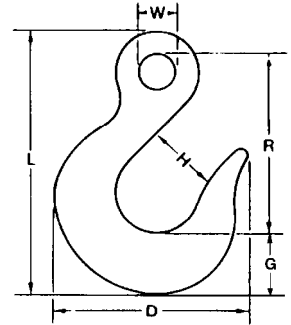
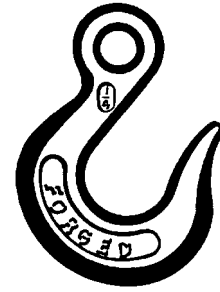

Chain size (in.)	Working load limit (lbs.)*	Clear finish		Zinc plated		Dimensions (inches)						Approx. weight each (lbs.)	Standard industrial pack
		Product code	UPC 43927-	Product code	UPC 43927-	W	D	H	L	R	G		
1/4	2,600	M304H	41488	M304HZ	41489	17/32	2 9/16	15/16	3 19/32	2 15/32	13/16	.42	20
5/16	3,900	M305H	41492	M305HZ	41493	5/8	3 1/16	1 1/16	4 3/32	2 25/32	15/16	.58	20
3/8	5,400	M306H	41496	M306HZ	41497	25/32	3 1/2	1 1/4	4 27/32	3 5/16	1 1/8	1.00	20
7/16	7,200	M307H	41500	M307HZ	41501	13/16	4 21/64	1 9/16	5 19/32	3 3/4	13/8	1.50	10
1/2	9,200	M308H	41504	M308HZ	41505	15/16	4 29/32	1 3/4	6 11/32	4 5/16	1 1/2	2.50	10
5/8	13,000	M310H	41508	M310HZ	41409	1 3/16	5 5/8	2	7 3/4	5 5/16	2 1/4	3.70	5
3/4	11,500	—	—	75793	81767-75793	1.53	6.14	2.06	8.60	6.5	1 15/16	6.50	5

CM alloy eye type chain hook

- Forged from alloy steel.
- Extra deep throat.
- Painted orange.
- Hooks embossed with chain grade.
- Grab hooks are compatible with grade 80 alloy chain except M207A.
- Slip hook compatible with grade 63 alloy chain.

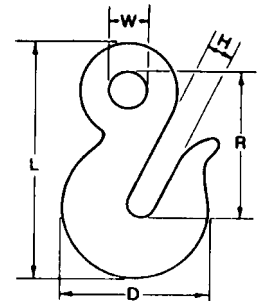

CM alloy eye type grade 80 grab hook

Hot forged, heat treated and tempered

Chain size (in.)	Working load limit (lbs.)*	Product code	UPC 43927-	Dimensions (inches)					Approx. weight each (lbs.)	Standard industrial pack
				W	D	H	L	R		
1/4	3,500	M204A	41516	17/32	2	3/8	3 7/32	2 1/32	.44	30
5/16	4,500	M205A	41520	5/8	2 13/32	7/16	3 25/32	2 13/32	.69	30
3/8	7,100	M206A	41527	25/32	2 11/16	1/2	4 11/32	2 3/4	1.00	30
7/16**	6,900	M207A	41533	13/16	3 3/64	37/64	4 55/64	3 11/64	1.20	20
1/2	12,000	M208A	41539	15/16	3 1/4	21/32	5 9/16	3 9/16	2.31	10
5/8	18,100	M210A	41543	1 1/16	4 11/32	25/32	7 1/16	4 9/16	4.00	10

**Grade 63

CM alloy eye type slip hook

Hot forged and heat treated

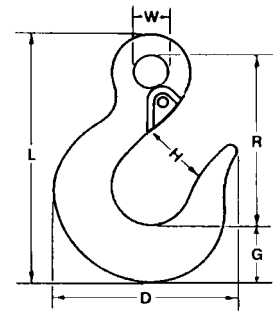
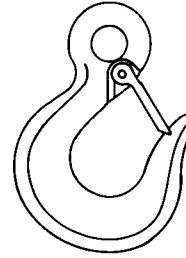
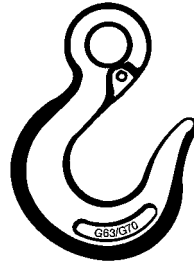

Chain size (in.)	Working load limit (lbs.)*		Hook		Latch kit**		Dimensions (inches)						Approx. weight each (lbs.)	Standard industrial pack
	Grade 63	Grade 70	Product code	UPC 43927-	Product code	UPC 43927-	W	D	H	L	R	G		
1/4	2,750	3,150	M6304	46196	4X404	41089	17/32	2 11/16	29/32	3 3/4	2 1/2	7/8	.45	20
5/16	3,600	4,700	M6305	46198	4X405	41090	5/8	3 3/16	13/64	4 13/32	3	1 1/32	.58	20
3/8	5,500	6,600	M6306	46200	4X406	41091	25/32	3 3/4	17/32	5 3/16	3 1/2	1 1/4	.98	20
7/16	7,100	8,750	M6307	46202	4X410	41092	13/16	4 21/64	17/16	5 3/4	3 29/32	1 3/8	1.50	10
1/2	9,400	—	M308A†	41562	—	—	15/16	4 29/32	1 3/4	6 11/32	4 5/16	1 1/2	2.50	10
5/8	14,200	—	M310A†	41566	—	—	13/16	5 5/8	2	7 3/4	5 5/16	2 1/4	3.10	5

**Stainless steel latch kit available. Latch is designed to retain such items as slings and chains under slack conditions. The latch is not intended to support the load.
†No latch hole.

CM rigging eye hook and latch—carbon

- Hook and latch assemblies furnished separately.
- All eye type hooks are furnished pre-drilled for latches.
- Hooks have a clear protective finish to resist rust and for cleaner handling.
- Use suffix “C” when ordering carbon clear finish.
- Carbon steel eye hooks for slings and rigging are available hot dip galvanized. Use suffix “G” when ordering.

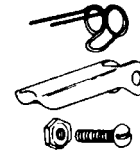
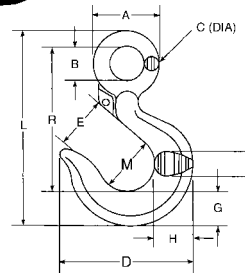
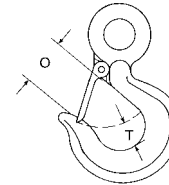

CM carbon steel hook

Hot forged, heat treated and tempered

Working load limit* (metric tons)†	Hook		Latch kit**		Dimensions (inches)												Approx. weight each (lbs.)
	Product code	UPC 43927-	Product code	UPC 43927-	A	B	C	D	E	G	H	K	L	R	T	O	
3/4	M404C	41005	4X404	41089	1.500	.750	.375	3.000	1.000	.750	.875	.562	4.375	3.125	.812	.875	.63
1	M405C	41011	4X405	41090	1.750	.875	.438	3.188	1.078	.844	.938	.625	4.938	3.656	.938	.938	.85
1 1/2	M406C	41018	4X406	41091	2.125	1.125	.500	3.625	1.125	1.000	1.156	.750	5.594	4.094	1.000	1.000	1.38
2	M407C	41025	4X406	41091	2.500	1.250	.625	4.094	1.250	1.125	1.312	.844	6.438	4.688	1.188	1.125	1.92
3	M410C	41032	4X410	41092	3.063	1.563	.750	5.063	1.531	1.438	1.625	1.125	7.969	5.781	1.438	1.375	3.70
5	M412C	41038	4X412	41093	3.875	2.000	.938	6.500	1.969	1.875	2.063	1.375	10.125	7.313	1.875	1.688	7.28
7 1/2††	M414C	45523	4X414	45529	4.685	2.441	1.122	7.598	2.244	2.480	2.606	1.850	12.500	9.055	2.380	2.047	15.40
11††	M416C	45524	4X416	45530	5.354	2.835	1.268	8.700	2.480	2.756	2.917	2.165	13.984	10.039	2.380	2.244	22.20
15††	M418C	45525	4X418	45531	6.614	3.504	1.555	11.102	3.346	3.228	3.516	2.598	17.126	12.480	2.500	2.992	37.60

**Stainless steel latch kit available. Latch is designed to retain such items as slings and chains under slack conditions. The latch is not intended to support the load.

†Metric ton = 2,204 lbs.
†† Imported.

CM rigging eye hook and latch—alloy

- Hook and latch assemblies furnished separately.
- All eye type hooks are furnished pre-drilled for latches.
- Painted orange.

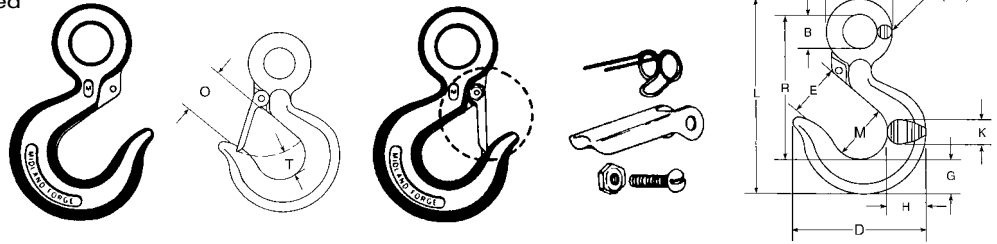

CM alloy steel hook

Hot forged, heat treated and tempered

Working load limit* (metric tons)†	Hook		Latch kit**		Dimensions (inches)														Approx. weight each (lbs.)
	Product code	UPC 43927-	Product code	UPC 43927-	A	B	C	D	E	G	H	K	L	M	R	T	O		
1	M404A	41046	4X404	41089	1.500	.750	.375	3.000	1.000	.750	.875	.562	4.375	1.250	3.125	.812	.875	.63	
1½	M405A	41051	4X405	41090	1.750	.875	.438	3.188	1.078	.844	.938	.625	4.938	1.375	3.656	.938	.938	.85	
2	M406A	41056	4X406	41091	2.125	1.125	.500	3.625	1.125	1.000	1.156	.750	5.594	1.438	4.094	1.000	1.000	1.38	
3	M407A	41065	4X406	41091	2.500	1.250	.625	4.217	1.250	1.274	1.431	.940	6.567	1.625	4.668	1.188	1.125	1.92	
5	M410A	41074	4X410	41092	3.063	1.563	.750	5.063	1.531	1.438	1.625	1.125	7.969	2.000	5.781	1.438	1.375	3.70	
7	M412A	41079	4X412	41093	3.875	2.000	.938	6.500	1.969	1.875	2.063	1.375	10.125	2.625	7.313	1.875	1.688	7.28	
11	M414A	45526	4X414	45529	4.688	2.438	1.125	7.688	2.250	2.250	2.625	1.900	12.434	3.000	9.034	2.297	2.053	15.40	
15††	M416A	45527	4X416	45530	5.354	2.835	1.268	8.700	2.480	2.756	2.917	2.165	13.984	3.307	10.039	2.380	2.244	22.20	
22††	M418A	45528	4X418	45531	6.614	3.504	1.555	11.102	3.346	3.228	3.516	2.598	17.126	3.937	12.480	2.500	2.992	37.60	

**Stainless steel latch kit available. Latch is designed to retain such items as slings and chains under slack conditions. The latch is not intended to support the load.
 † Metric ton = 2,204 lbs.
 †† Imported.

CM alloy shank hooks

- Heat treated alloy steel provides strength without bulk or weight
- Pre-drilled boss allows for addition of a latch.
- Hardness approximately R30_C-36_C
- Shank hooks are supplied unthreaded. Insufficient thread engagement can result in loss of load. The following must be observed:
 - 1) Shanks are not intended for internal threading or swaging.
 - 2) To obtain maximum strength threads to be class 1 or 2.
 - 3) Thread engagement in nut or object must be a minimum of 1½ times the thread diameter.

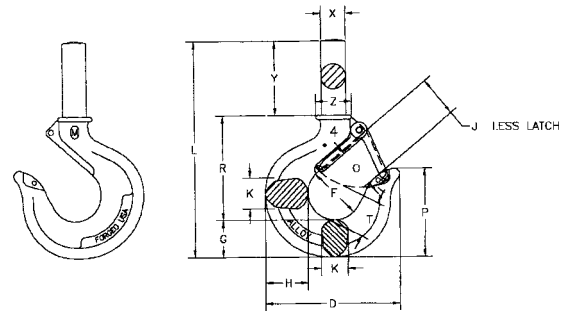

Hook no.	Product code*	UPC 43927-	Alloy W.L.L.	Max. shank dia. after machining	Min. thread size (UNC)	Dimensions (inches)														Latch hole dia.	Latch kit code
						D	F	G	H	J	K	L	O	P	R	T	X	Y	Z		
2	M1302A	46294	1	.53	1/2-13	3.06	1.25	.87	1.05	.93	.63	5.28	.93	2.12	2.35	.87	.59	2.06	.69	.144	4X1302
3	M1303A	46295	1.5	.62	5/8-11	3.33	1.38	.94	1.11	.97	.71	5.78	.97	2.27	2.59	.97	.66	2.25	.78	.180	4X1303
4	M1304A	46296	2	.66	5/8-11	3.67	1.50	1.06	1.21	1.06	.88	6.29	1.06	2.54	2.75	1.03	.72	2.50	1.00	.180	4X1304
5	M1305A	46297	3	.81	3/4-10	4.20	1.63	1.27	1.43	1.19	.94	7.26	1.16	2.80	3.16	1.16	.88	2.84	1.00	.180	4X1305
6	M1306A	46298	3.5	.94	7/8-9	4.74	1.63	1.42	1.59	1.38	1.00	7.55	1.28	3.23	3.13	1.06	1.00	3.00	1.16	.203	4X1307
7	M1307A	46299	5	1.03	7/8-9	5.11	2.00	1.44	1.63	1.50	1.31	8.63	1.41	3.47	3.85	1.53	1.16	3.34	1.25	.203	4X1307
8	M1308A	46300	5.5	1.13	1-8	6.04	2.25	1.69	1.98	1.75	1.44	11.81	1.66	4.06	4.13	1.28	1.22	6.00	1.44	.203	4X1309
9	M1309A	46301	7	1.27	1 1/8-7	6.24	2.50	1.82	2.01	1.78	1.68	10.43	1.69	4.59	4.77	1.94	1.41	3.84	1.56	.203	4X1309
11	M1311A	46302	11	1.52	1 3/8-6	7.69	3.00	2.25	2.63	2.41	1.88	12.50	2.22	5.63	5.88	2.46	1.81	4.38	2.00	.257	4X1311

*Order latch kit separately.

*** ⚠ WARNING**

TO AVOID INJURY:

- Do not exceed working load limit.
- Use only alloy chain and attachments for overhead lifting.

CM replacement hooks with latch

- Attaches easily to standard chain of electric hoist using welded link load chain, roller chain or wire rope with applicable end fitting
- Swivel jaw is forged

Product code	UPC 43927-	Working load limit* (tons)	Dimensions (inches)					Approx. weight each (lbs.)
			B	C	L	O	R	
M133	46039	1/2	.438	.500	6.42	1.000	4.89	2.00
M134	46020	1	.437	.500	7.56	1.125	5.625	2.56

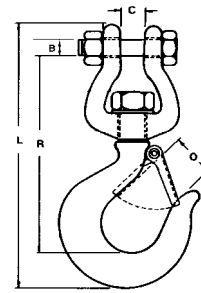

CM alloy swivel hooks

- Alloy steel
- Heat treated, quenched & tempered
- Design factor 5-1
- Built in distortion detectors
- Pre-drilled for 1300 series latch kits

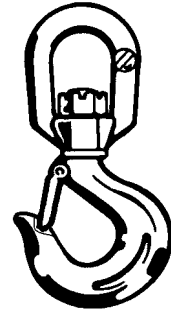
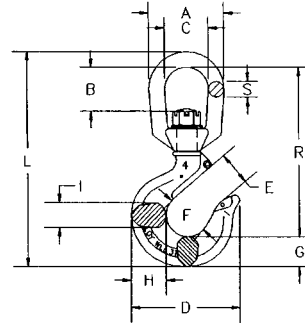
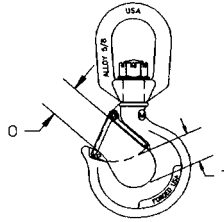

Without latch

Hook product code	UPC 43927-	Working load limit* (tons)	Dimensions (inches)															Approx. weight each (lbs.)	Latch kit (optional)
			A	B	C	D	E	F	G	H	I	L	R	S	T	O			
M3402A	46280	1	2.00	1.11	1.25	3.15	1.00	1.25	.87	1.00	.63	5.88	4.63	.38	.81	.88	1.00	4X1302	
M3403A	46281	1 1/2	2.50	1.38	1.50	3.47	1.08	1.38	.96	1.11	.72	6.89	5.44	.50	.94	.94	1.50	4X1303	
M3404A	46282	2	3.00	1.65	1.75	3.78	1.13	1.50	1.04	1.21	.86	7.93	6.25	.63	1.00	1.00	2.60	4X1304	
M3405A	46283	3	3.00	1.65	1.75	4.22	1.25	1.63	1.27	1.43	.94	8.25	6.49	.63	1.19	1.13	3.10	4X1305	
M3407A	46284	5	3.50	1.77	2.00	5.07	1.53	2.00	1.44	1.62	1.15	9.72	7.53	.75	1.44	1.38	5.30	4X1307	
M3409A	46285	7	4.75	2.39	2.75	6.30	1.97	2.50	1.74	2.01	1.51	12.41	9.60	1.00	1.88	1.69	10.40	4X1309	
M3411A	46286	11	5.50	2.55	3.25	7.69	2.25	3.00	2.25	2.63	1.90	15.43	12.06	1.13	2.31	1.94	16.25	4X1311	

Assembled with latch

Product code	UPC 43927-	Working load limit* (lbs.)	Approx. weight each (lbs.)
M3502A	46287	1	1.5
M3503A	46288	1 1/2	2
M3504A	46289	2	3
M3505A	46290	3	3.5
M3507A	46291	5	7.5
M3509A	46292	7	14
M3511A	46293	11	16.25

CM claw hook

- Especially designed for easy hook-up to loose or taut chain with one hand connection.
- Drop forged from special bar quality steel.
- Heat treated for greater strength and increased wear characteristics.
- Allows full joint strength when used with high test grade 43 or transport grade 70 chain.
- Clear protective finish resists rust and provides cleaner handling.
- For use with 3/8" G43 or G70 chain.
- Working load limit 6,600 lbs.

Product code	UPC 43927-	Dimensions (inches)								Factory pack**	Approx. weight each (lbs.)
		A	B	C	D	E	F	G			
M206C	41356	2 5/32	4 3/16	1/2	1 1/16	1 5/8	—	—	10	1.15	
M806C	41350	2 5/32	4 1/8	15/32	—	—	7/16	1/2	10	1.20	

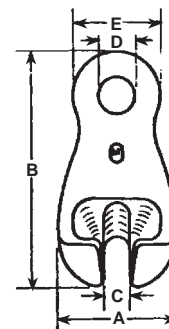

Eye type
Part no. M206C

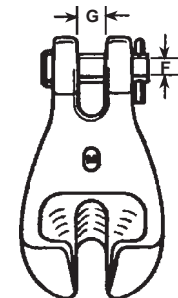

Clevis type
Part no. M806C

**Bulk pack on request.

M3400A and M1300 series hook latches



OLD STYLE

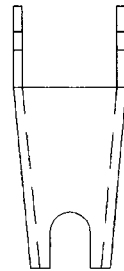

NEW STYLE

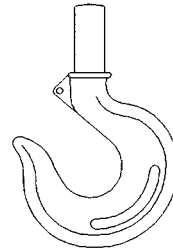

OLD STYLE

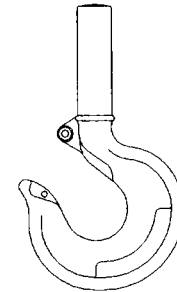

NEW STYLE

Alloy Working load limit (lbs.)*	Latch				Hook			
	Old style code	UPC 43927-	New style code	UPC 43927-	Old style code	UPC 43927-	New style code	UPC 43927-
1	4X405	41090	4X1302	46273	M3402	45910	M3402A	46280
1.5	4X405	41090	4X1303	46274	M3403	45911	M3403A	46281
2	4X406	41091	4X1304	46275	M3404	45912	M3404A	46282
3	4X406	41091	4X1305	46276	M3405	45913	M3405A	46283
5	4X410	41092	4X1307	46277	M3407	45914	M3407A	46284
7	4X412	41093	4X1309	46278	M3409	45915	M3409A	46285
11	—	—	4X1311	46279	—	—	M3411A	46286

Replacement latch kit for M3400A and M1300 series hooks

- Heavy duty latch interlocks with hook tip.
- High cycle, durable spring.
- Can be made into a “positive locking” hook when proper twist clip is utilized.

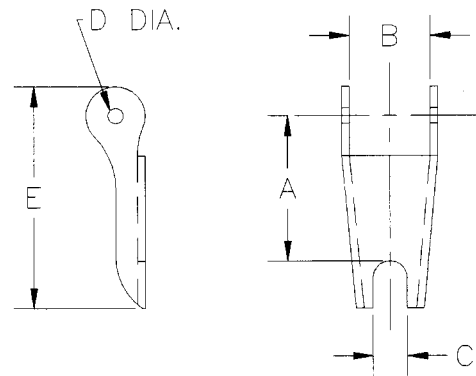

Alloy Working load limit (lbs.)*	Latch kit code	UPC 43927-	Weight each (lbs.)	Dimensions				
				A	B	C	D	E
1	4X1302	46273	.03	.94	.50	.20	.15	1.44
1.5	4X1303	46274	.04	1.00	.54	.22	.17	1.56
2	4X1304	46275	.04	1.09	.63	.23	.17	1.66
3	4X1305	46276	.06	1.21	.66	.28	.17	1.91
5	4X1307	46277	.10	1.53	.83	.35	.20	2.31
7	4X1309	46278	.15	1.88	1.04	.44	.20	2.88
11	4X1311	46279	.28	2.38	1.25	.53	.27	3.44

***▲WARNING**

TO AVOID INJURY:

- Do not exceed working load limit.
- Use only alloy chain and attachments for overhead lifting.

Warnings and application instructions

This latch is intended to only retain loose slings or devices under slack conditions. Caution must be used to assure that the latch does not support any of the load. Periodic inspection of the latch must be made to assure that the latch is operative. If a latch becomes inoperative because of wear or deformation, or fails to fully bridge the throat opening, the hook should be removed from service until the device has been repaired or replaced.

Important safety information to be followed each time hook is used

- Refer to OSHA regulations 29 CFR Ch. XVII, Section 1926.550, subpart N-Cranes, Derricks, Hoists, Elevators, and Conveyors for positive locking applications. Only CM hook & latch combinations may be used for positive locking applications (when twist clip 15 engaged through the hook tip)!
- Inspect hook and latch before using.
- Never use a latch that is distorted, bent, or has been modified, (do not use latch with substituted components)!
- Check to make sure spring will force latch against tip of the hook.
- Check to make sure hook supports the load. The latch must never support the load.
- Check to make sure when the twist clip is in place, that the latch tightly fits the throat opening of the hook.
- Check to make sure that correct rigging and operating practices are being used.

CM hook & latch combinations		
Part no.		
Alloy shank hook	Swivel hook	Latch no.
M1302A	M3402A	4X1302
M1303A	M3403A	4X1303
M1304A	M3404A	4X1304
M1305A	M3405A	4X1305
M1306A	—	4X1307
M1307A	M3407A	4X1307
M1308A	—	4X1309
M1309A	M3409A	4X1309
M1311A	M3411A	4X1311

Important—instructions for assembling the positive locking latch

For assembly to hook

1. Line up holes in latch with cam.
2. Insert bolt through latch, spring and cam.
3. Tighten self-locking nut on latch pivot bolt.

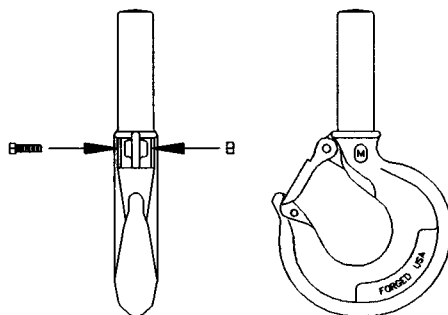

FIGURE 1

For positive locking applications

1. With latch in closed position and rigging slack in bowl of hook, put twist clip through hook tip to secure latch in place. When not using the twist clip, store in a designated place.

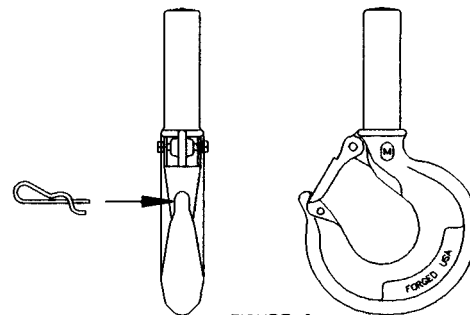
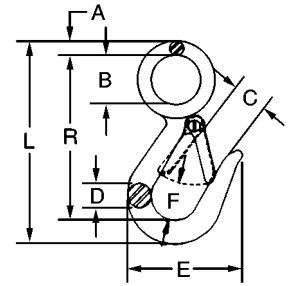

FIGURE 2

CM snap hook—forged steel, heat treated

- Stainless steel latches, springs, bolts and nuts.
- Ultimate load is 4 times the working load limit.



Hook size (in.)	Working load limit (lbs.)*	Product code	UPC 43927-	Dimensions (inches)								Approx. weight each (lbs.)
				A	B	C	D	E	F	L	R	
7/16	750	495116	34235	1/4	3/4	3/4	.44	2 1/4	3/4	3 15/16	3 1/4	.25

CM aircraft tie-down hook/chain type

- Strengths are compatible with 9/32" alloy chain having a working load limit of 4100 lbs.
- Forged from special bar quality alloy steel.
- Ref. Dept. of Navy P/N 61A101B10.
- Quenched and tempered for better mechanical properties.
- Normal self colored finish. Can be painted or hot dip galvanized.

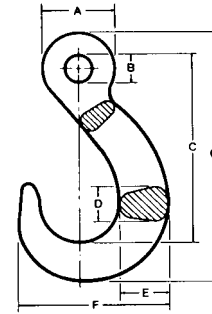

Product code	UPC 43927-	Dimensions (inches)							Approx. weight each (lbs.)
		A	B	C	D	E	F	G	
M130SC	42003	1 5/16	17/32	3 11/16	11/16	15/16	2 27/32	4 25/32	.63

CM aircraft tie-down hook/cargo type

- Strengths are compatible with 9/32" alloy chain having a working load limit of 4100 lbs.
- Forged from special bar quality alloy steel.
- Quenched and tempered for better mechanical properties.
- Normal self colored finish. Can be painted or hot dip galvanized.

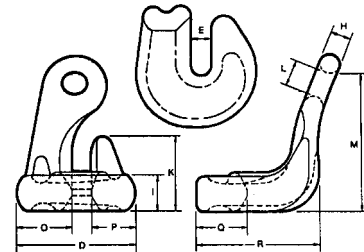

Hook size (in.)	Product code	UPC 43927-	Dimensions (inches)											Approx. weight each (lbs.)
			D	E	H	I	K	L	M	O	P	Q	R	
9/32	474227	42002	2 7/32	3/8	11/32	21/32	13/8	1/2	2 5/8	11/32	13/16	15/16	2 19/64	.89

CM sorting hook

- Forged from special bar quality steel - heat treated
- Special construction for efficient handling of flat plates or large cylindrical shapes.
- Long tapered point designed for easy grab in rings, pear links, eyebolts or lifting holes.
- Painted orange.
- Design ultimate strength is 5 times working load limit.

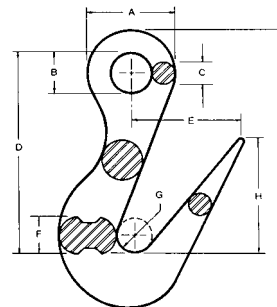

Working load limit at tip (tons)*	Working load limit at bottom of hook (tons)*	Product code	UPC 43927-	Dimensions (inches)							Approx. weight each (lbs.)		
				A	B	C	D	E	F	G		H	I
2	7 1/2	M129	41511	3	17/16	25/32	7 11/32	3 3/4	19/32	1 1/4	4 1/8	10 3/32	6.8

* ⚠ WARNING

TO AVOID INJURY:

- Do not exceed working load limit.
- Use only alloy chain and attachments for overhead lifting.

Dixie—tarp hook

- Zinc plated



Size diameter (in.)*	Product code	UPC 81767-	Approx. weight each (lbs.)	Standard industrial pack
3/8	57311	57311	1.5	20

CM trek hook

- Forged from special bar quality steel.
- Ref. Army Ord. Corps P/N 7339460.
- Normal self colored finish. Can be painted or hot dip galvanized to ASTM A153.
- Design ultimate strength equals 4 times working load limit.

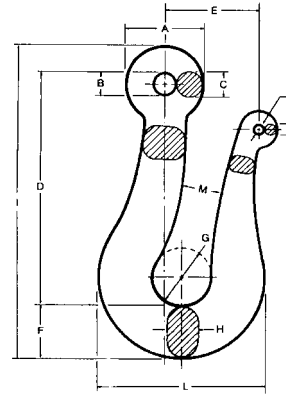

Working load limit (lbs.)*	Product code	UPC 43927-	Dimensions (inches)													Approx. weight each (lbs.)
			A	B	C	D	E	F	G	H	I	J	K	L	M	
2,650	M128SC	41364	15/8	1/2	9/16	5	2	1 1/8	1 1/4	11/16	6 11/16	1/4	5/16	3 1/2	29/32	2.0

CM quick link

- Imported



For chain size (in.)	Working load limit (lbs.)*	Carton		Std. pack	Gap (in.)	Inside width (in.)	Inside length (in.)	Approx. weight display pack (lbs.)
		Product code	UPC 43927-					
1/8	220	81901	81767-81901	20	13/64	25/64	19/64	.6
3/16	615	D81001	35975	20	1/4	1/2	1 1/2	4 1/2
1/4	880	D81101	35956	20	9/32	9/16	1 3/4	8
5/16	1,540	D81201	35957	20	3/8	11/16	2 5/16	17
3/8	1,980	D81301	35958	10	7/16	3/4	2 7/16	23
1/2	3,300	D81501	35983	10	19/32	15/16	3 3/16	51

Applications: Used as a repair link, connecting link or attaching device.
 Description: Zinc plated, not heat treated. Use only with chain of equal or lower working load limit. Not to be used for load securement (tie-down).

CM repair link



Trade size (in.)	Working load limit (lbs.)*	Carton				Pieces per carton	Inside length (in.)	Inside width (in.)	Approx. weight each (lbs.)
		Bright finish		Zinc plated					
		Product code	UPC 43927-	Product code	UPC 43927-				
3/16 x 1	240	653180	53180	653618	34843	100	1	1/2	.035
7/32 x 1 1/4	250	653211	53211	653621	35115	50	1 1/4	1/2	.055
1/4 x 1 1/4	400	653251	53251	653625	34844	50	1 1/4	1/2	.075
1/4 x 2	400	653255	34897	653627	35141	50	2	5/8	.105
5/16 x 1 1/2	950	653312	34900	653631	34845	50	1 1/2	3/4	.145
5/16 x 2	1,000	653315	34913	653632	35561	50	2	3/4	.170
3/8 x 1 5/8	1,250	653373	53373	653633	34846	50	1 5/8	3/4	.230
3/8 x 2	1,250	653375	35049	653638	35568	50	2	3/4	.240

Applications: A temporary repair link also used to couple light attachments.
 Description: A mild steel, available with bright, hot galvanized or zinc plated finishes. Not to be used for load securement (tie-down).

Dixie—swivels

- Imported



Trade size (in.)	Working load limit (lbs.)*	Product code	UPC 81767-	Approx. weight each (lbs.)
3/16	590	89511	89511	.21
3/8	2,350	89514	89514	.73

3/16" supplied in packs of 10
 3/8" supplied 10 per card

*** ⚠ WARNING**

TO AVOID INJURY:

- Do not exceed working load limit.
- Use only alloy chain and attachments for overhead lifting.

CM cold shut



Trade size (in.)	Working load limit (lbs.)*	Zinc plated bulk (ea.)		Zinc plated carton (10)		Self colored bulk (ea.)		Inside length (in.)	Inside width (in.)	Approx. weight each (lbs.)
		Product code	UPC 43927-	Product code	UPC 43927-	Product code	UPC 43927-			
3/16	525	D50091	22781	—	—	D50090	35984	15/16	5/16	.03
1/4	800	D50191	22782	673104	34175	D50190	35985	1	3/8	.05
5/16	1,300	D50291	22783	673105	34176	D50290	39013	1 3/16	7/16	.11
3/8	1,900	D50391	22784	673106	34177	D50390	20287	1 5/16	1/2	.17
7/16	2,650	D50491	29362	673107	34178	D50490	20288	1 1/2	9/16	.27
1/2	3,500	D50591	29363	673108	34179	D50590	20289	1 9/16	3/4	.39
5/8	4,500	D50691	29364	673110	34180	D50690	20290	2 1/8	7/8	.77
3/4	6,900	—	—	51791	81767-51791	—	—	2 11/16	1	1.28

Applications: As temporary repair link, use one size larger than proof coil chain (grade 30) with which it is to be used.
 Also used to couple light attachments.
 Description: Low carbon steel, self colored or zinc plated finish.
 Not to be used for load securement (tie-down).

CM “S” hook



Fig. 1



†Fig. 2

Hook number	Working load limit (lbs.)*	Self colored carton		Zinc plated carton		Wire size	Inside length (in.)	Throat opening (in.)	Approx. weight per 100 (lbs.)
		Product code	UPC 43927-	Product code	UPC 43927-				
20	16	687120	34381	687420	34398	.080	27/32	5/32	1/4
21	16	687121	34382	687421	34399	.080	11/16	5/32	1/4
40	42	687140	34383	687440	34409	.134	1	5/16	1
60	75	687160	34384	687460	34410	.192	1 11/16	7/16	3 3/4
61	120	687161	34385	687461	34411	.204	1 5/8	7/16	3 7/8
62†	95	687162	34386	687462	34412	.175	1 3/8	9/16, 1/4	2 1/2
72†	130	687172	34388	687472	34414	.225	1 1/2	5/16, 3/8	4 3/4
80	160	687180	34389	687480	34415	.250	1 3/4	7/16	6 1/4
81	150	687181	34390	687481	34416	.250	2 1/2	7/16	8
84†	190	—	—	687484	34417	.250	1 25/32	5/16, 1/2	6 1/4
100	290	687190	34391	687490	34418	.312	2 1/4	7/16	11 3/4
120	410	687192	—	687492	34419	.375	2 3/8	1/2	19 1/2

†Figure 2
 Applications: Used to attach various accessories to chain. Low working load limits only.
 Description: Mild steel, bright, zinc plated.
 Packaging: 50 pieces in a carton.

CM welded ring



Material size and diameter (in.)	Working load limit (lbs.)*	Carton				Pieces per carton	Approx. weight each (lbs.)
		Bright finish		Zinc plated			
		Product code	UPC 43927-	Product code	UPC 43927-		
3/16 x 1 1/4	200	660150	—	660450	34524	25	.0325
3/16 x 2	150	660152	34518	660452	34525	25	.0525
1/4 x 1 1/2	450	660153	34519	660453	34526	25	.0775
1/4 x 2	350	660155	34520	660455	34527	25	.0975
5/16 x 2	600	660156	34521	660456	34528	25	.1600
3/8 x 2	900	660157	34589	660457	34590	25	.2325
1/2 x 2 1/2	1,300	660158	34522	660458	34601	10	.6000
5/8 x 4	1,700	660159	34523	660459	34602	10	1.4500

Applications: A chain attachment for general use.
 Description: Low carbon steel. Finishes are bright or zinc plated.

CM mid-link

- For permanent or temporary use.
- Forged and heat treated.
- Heat treated pins.
- “HT” forged on mid-link indicates high test chain. Also used on G30.
- Bright zinc plated to resist rust and for cleaner handling.
- Four numbers fit six sizes of chain.
- Reusable—easy to install or remove.
- Design ultimate strength equals 3 times working load limit.

- M605 & M606 compatible with G70 chain.
- Approved C.V.S.A. repair link.

On-the-job repair possible for truck boomer tie-down chains. Also handy in the toolbox to lengthen chain for special jobs.

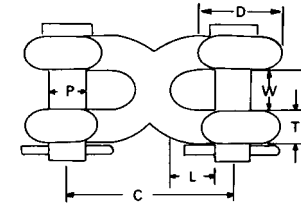
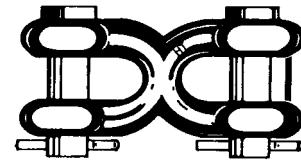

Chain size (in.)	Working load limit (lbs.)*	Product code	UPC 43927-	Dimensions (inches)						Factory pack	Weight factory pack (lbs.)
				W	T	L	C	P	D		
1/4 or 5/16	4,700	M605	42838	7/16	5/16	3/8	19/16	3/8	15/16	10	4
3/8	6,600	M606	42849	1/2	3/8	15/32	113/16	7/16	1	10	5
7/16 or 1/2	11,300	M608	42860	5/8	1/2	19/32	2 5/16	9/16	15/16	5	5
5/8	15,800	M610	42871	3/4	5/8	3/4	2 13/16	11/16	1 1/2	5	8.5

Dixie—double clevis link

- Use with Grade 30, 43 & 70 chain

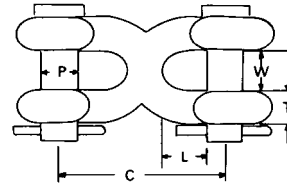

Chain size (in.)	Working load limit (lbs.)*	Product code	UPC 81767-	Dimensions (inches)					Factory pack	Weight factory pack (lbs.)
				W	T	L	C	P		
5/16	4,700	82180	82180	7/16	5/16	1/2	1 3/4	3/8	10	4
3/8	6,600	82380	82380	1/2	7/16	1/2	2	7/16	10	6.40
1/2	11,300	82480	82480	5/8	1/2	1 1/16	2 9/16	9/16	5	7

CM connecting link

- Hot forged using special bar quality steel.
- Heat treated for strength and increased wear.
- Meets or exceeds Fed. Spec. RR-C-271D.
- Marked with size and grade (G30) for proper application.
- Design load equals 4 times working load limit.
- Precision parts mate together easily for better fit.
- Interlocking lugs and integral rivets on all sizes except 3/16", 1/4" and 5/16" which have rivets only.
- Clear protective finish resists rust. Also available in electro-galvanized finish. Hot dip galvanized available upon request.

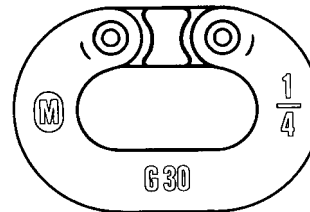

Chain size (in.)	Working load limit (lbs.)*	Clear finish		Electro-galvanized		Factory pack	Approx. weight each (lbs.)
		Product code	UPC 43927-	Product code	UPC 43927-		
3/16	800	M613†	43204	M613G	43205	10	.03
1/4	1,300	M614†	43209	M614G	43210	10	.08
5/16	1,900	M615†	43215	M615G	43216	10	.12
3/8	2,650	M616†	43221	M616G	43222	10	.20
7/16	3,700	M617†	43226	M617G	43227	10	.24
1/2	4,500	M618†	43231	M618G	43232	5	.42
5/8	6,900	M620†	43237	M620G	43238	5	.75
3/4	10,600	M622	43241	M622G	43242	Bulk	1.16
7/8	12,800	M624	43245	M624G	43246	Bulk	1.75
1	17,900	M626	43249	M626G	43250	Bulk	2.40

Packed unassembled.
†M613-M618 are poly bagged; M620 boxed.

IMPORTANT: Big Orange connecting links are designed for use as repair links for G30 chain only.
They are not to be used for lifting and not to be used for load securement (tie-down).

CM D ring

- Finish: painted, zinc plated or galvanized.
- Heat treated.
- Manufactured to meet our interpretation of ICC, OSHA, ANSI B30.9 and California Highway Patrol Title 13 requirements when used with 4" webbing.

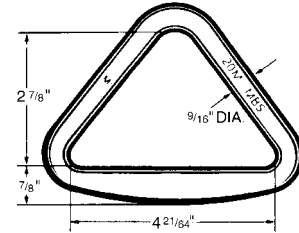

Webbing width (in.)	Working load limit (lbs.)*	Product code	UPC 43927-	Min. ultimate breaking strength (lbs.)	Approx. weight each (lbs.)
4	4,000	M162	43301	24,000	1.13

CM alloy forged master link – 100% proof tested

- Drop forged using special bar quality alloy steel.
- Quenched and tempered heat treatment for improved strength.
- Individually proof tested at 2 times working load limit.
- Design ultimate strength is 5 times working load limit.
- Orange paint finish.
- Large inside widths to accommodate more applications.
- Markings are raised characters for better identification to assist proper application.

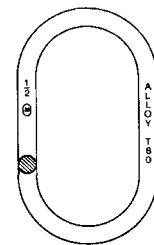

Working load limit (lbs.)*	Product code	UPC 43927-	Dimensions (inches)			Approx. weight each (lbs.)
			Stock dia.	Inside width	Inside length	
5,100	M50P	43316	1/2	2 1/2	5	.94
7,700	M62P	43321	5/8	3	6	1.75
10,600	M75P	43323	3/4	3	6	2.50
20,400	M100P	43313	1	4	8	5.80

CM clevis link

- Drop forged from special bar quality steel.
- Heat treated for greater strength and increased wear characteristics.
- Metric marked.
- Clear protective finish resists rust and provides cleaner handling.
- For rigging not involving overhead lifting.

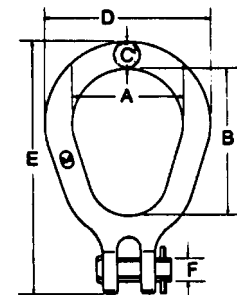

Chain size (in.)	Working load limit (lbs.)*	Product code	UPC 43927-	Dimensions (inches)						Factory pack**	Approx. weight each (lbs.)
				A	B	C	D	E	F		
5/16	4,400	695443	41361	2 1/8	3 3/16	9/16	3 17/64	5 15/32	25/64	10	.94
3/8	6,600	695444	41362	2 1/8	3 3/16	21/32	3 27/64	5 19/32	15/32	10	1.19

**Bulk pack on request.

***▲WARNING**

TO AVOID INJURY:

- Do not exceed working load limit.
- Use only alloy chain and attachments for overhead lifting.

CM lever type load binder

- Provides more control in binding and releasing without extra tools.
- Handle closes down away from load with more leverage.
- Functionally superior to any other on the road.
- Handles are drop forged from special bar quality steel.
- Hooks are heat treated steel.
- Single welded links as in binder chain for better reliability.
- More take-up for binding greater loads. Smaller handle slot with riveted nose to prevent spreading at the critical loading point.
- Meets D.O.T. and C.V.S.A. requirements.

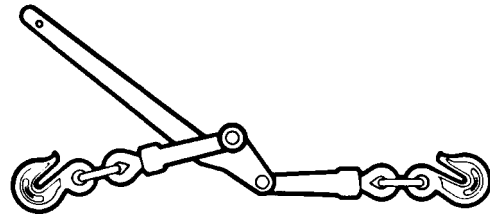

Chain size (in.)	Chain grade	Working load limit (lbs.)*	Product code	UPC 43927-	Handle length (in.)	Take-up (in.)	Approx. weight each (lbs.)
1/4	G30, 43	2,600	M104	42642	11 1/4	3	2 1/2
1/4	G30, 43, 70	5,400	M105	42644	16	4 7/8	8 1/4
5/16	G30, 43, 70	5,400	M105	42644	16	4 7/8	8 1/4
3/8	G30, 43	5,400	M105	42644	16	4 7/8	8 1/4
5/16	G30, 43, 70	9,200	M106	42647	18 1/2	5 1/8	11 1/4
3/8	G30, 43, 70	9,200	M106	42647	18 1/2	5 1/8	11 1/4
7/16	G30, 43	9,200	M106	42647	18 1/2	5 1/8	11 1/4
1/2	G30, 43	9,200	M106	42647	18 1/2	5 1/8	11 1/4

CM claw hook load binder

- Same reliable design and construction as lever type load binder.
- Equipped with claw hooks for easy one-handed connection to loose or taut chain.
- Meets D.O.T. and C.V.S.A. requirements.

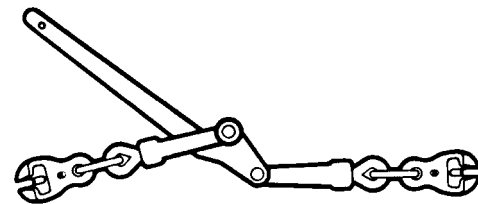

Chain size (in.)	Chain grade	Working load limit (lbs.)*	Product code	UPC 43927-	Handle length (in.)	Take-up (in.)	Approx. weight each (lbs.)
1/4	G30, 43, 70	5,400	M105C	42645	16	4 7/8	8 1/2
5/16	G30, 43, 70	5,400	M105C	42645	16	4 7/8	8 1/2
3/8	G30, 43	5,400	M105C	42645	16	4 7/8	8 1/2

Load binder operating instructions

1. Follow D.O.T. Federal Motor Carrier Safety Regulations S 392.9, S 393.100, and S 393.102.
2. Inspect before use. Replace worn and deformed binders. Lubricate pivot and swivel points for optimum performance.
3. Do not operate with anyone on load.
4. Always apply lever binder in a straight line hook to hook manner without bending and such that handle goes down when securing load.
5. Tighten binders before moving and recheck frequently.
6. Do not exceed working load limit shown on binder—hand effort will tighten binder to working load limit.
7. Do not use cheater bar or handle extension as their use can overload binder system and result in injury.
8. Secure handle down with a positive retaining method.
9. Release handle/load with extreme care. Make sure everyone is clear. Lever binder handle can snap back over center. Use open palm under handle and push up.

* ⚠ WARNING

LOAD BINDING SYSTEMS STORE ENERGY WHICH CAN RELEASE SUDDENLY.

To avoid injury, operate only by hand from a firm standing position. Operate handle cautiously. Stay clear of handle path: handle may release suddenly. Follow instructions.

Poultry lever load binder

- 48355 has 1/4" binder with 18" G43 chain & ring
- 48356 has 1/4" binder with 18" G43 chain and 5/16" G43 Grab Hook

Chain size (in.)	Chain grade	Working load limit (lbs.)*	Product code	UPC 81767-	Take-up (in.)	Handle length (in.)	Approx. weight each (lbs.)
1/4	G30, 43	2,600	48355	48355	2 3/4	11 1/4	4.7
1/4	G30, 43	2,600	48356	48356	2 3/4	11 1/4	4.7

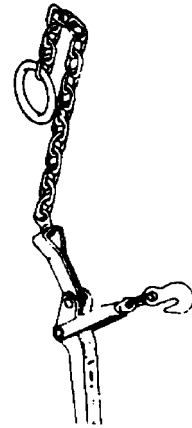

CM malleable lever load binder

- Free turning 360° swivels on both hooks for easier handling and better utility.
- Front tongue for greater take-up.
- Special handle angle prevents finger trap.
- Drop forged, short reach hooks for maximum take-up.
- Meets D.O.T. and C.V.S.A. specifications.

G30 max. size (in.)	Working load limit (lbs.)*	Product code	UPC 43927-	Take-up (in.)	Handle length (in.)	Approx. weight each (lbs.)
1/4	2,600	D48314	24252	2 3/4	11 1/4	2 7/8
3/8	5,400	D48315	23029	4 1/2	16	7 3/4
1/2	6,000	D48316	24253	4 1/2	19	11 3/4

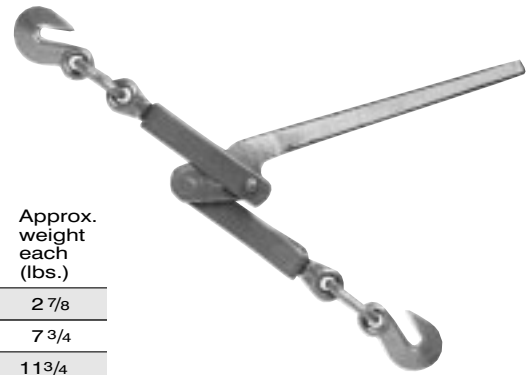

Ratchet type load binder

- Heavy duty, rigid, all steel construction.
- Short reach hooks for maximum take-up.
- Infinite adjustment.
- Continuous take-up.
- Meets D.O.T. and C.V.S.A. specifications.

Max. size (in.)		Working load limit (lbs.)*	Product code	UPC 43927-	Take-up (in.)	Approx. weight each (lbs.)
—		13,000	D48363**	30002	8	11
5/16 3/8	G70 G43	5,400	D48365	30003	8	12 1/4
3/8 1/2	G70 G43	9,200	D48366	31205	8	12 1/4
5/16 3/8	G70 G43	5,400	D48810	21059	6	7 3/4
3/8 5/16	G80, G43 G70	7,100	D48360	81767- 48360	8	13
1/2 5/8	G70 G43	13,000	D48367	30008	8	14

**Supplied without hooks.



CM tightener load binder

- Features swivel hook for easier operation.
- Either hook may be permanently attached to chain.
- Rugged cast construction with formed hooks.

Working load limit (lbs.)*	Product code	UPC 43927-	Take-up (in.)	Handle length (in.)	Approx. weight each (lbs.)
375	D48949	31206	3	9 1/2	2



Specialty forged lever load binder

Chain size (in.)	Chain grade	Working load limit (lbs.)*	Product code	UPC 81767-	Take-up (in.)	Handle length (in.)	Approx. weight each (lbs.)
3/8	G30, 43	5,400	48395	48395	4 1/2	16.62	14.6
5/16	G70	5,400	48395	48395	4 1/2	16.62	14.6

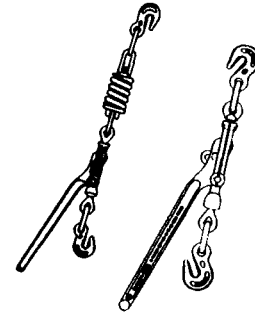

CM drop forged load binder

- All steel.
- Drop forged.
- Both hooks swivel 360°.
- Each binder individually proof tested.
- Tie-down hole in handle.
- Short reach hooks for maximum take-up.
- Heavy, rigid construction.
- Special manufacturing permits use with transport grade 70 chain.
- Meets D.O.T. and C.V.S.A. specifications.

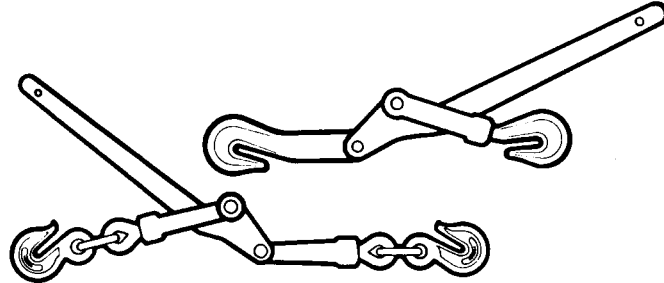

Working load limit (lbs.)*	Product code	UPC 43927-	Chain grade & size (in.)			Handle length (in.)	Take-up (in.)	Approx. weight each (lbs.)
			G30	G43	G70			
2,600	320104	32146	1/4	1/4	—	11 1/4	3	2 1/2
5,400	320105	24251	3/8	3/8	5/16	16 1/8	4 1/4	8
9,200	D48306	21424	1/2	1/2	3/8	16 5/8	4 1/2	10

CM E-Z Pro cam release lever binder

- Provides recoilless CAM release design.
- Entirely hand releasable.
- Individually proof tested.
- Use with grade 43 and grade 70 chain.

Chain grade & size (in.)		Working load limit (lbs.)*	Product code	UPC 43927-	Take-up (in.)	Approx. weight each (lbs.)	Std. Pack
G43	G70						
3/8	5/16	5,400	D48405	23028	4 1/2	11	4

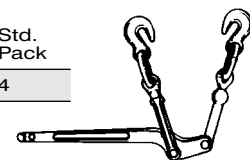



HALO

GRADE 80 CLEVIS CRADLE GRAB HOOKS



Chain Size	A	B	P	R	W.L.L. (lbs.)	Wt. Ea. (lbs.)
9/32"	25/64"	25/64"	25/64"	1-31/32"	3500	0.6
3/8"	33/64"	33/64"	33/64"	2-53/64"	7100	1.65
1/2"	43/64"	43/64"	5/8"	3-15/32"	12000	2.98
5/8"	25/32"	53/64"	53/64"	4-1/64"	18100	5.07
3/4"	61/64"	61/64"	61/64"	4-39/64"	28300	9.04

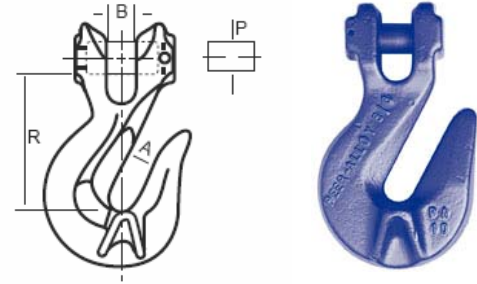

Never Exceed Working Load Limit

GRADE 80 SLING HOOKS WITH LATCH



Chain Size	A	B	P	R	W.L.L. (lbs.)	Wt. Ea. (lbs.)
9/32"	1-3/16"	11/32"	25/64"	3-25/64"	3500	1.19
3/8"	1-13/32"	31/64"	33/64"	4-9/64"	7100	2.2
1/2"	1-11/16"	39/64"	5/8"	5-1/16"	12000	4.25
5/8"	2-1/16"	3/4"	53/64"	6-7/64"	18100	7.6
3/4"	2-17/32"	7/8"	1-1/16"	5-39/64"	28300	13.1

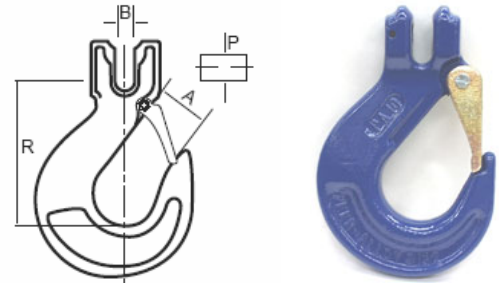

Never Exceed Working Load Limit

GRADE 80 FOUNDRY HOOKS



Chain Size	A	D	O	R	W.L.L. (lbs.)	Wt. Ea. (lbs.)
9/32"	2-31/64"	15/32"	33/64"	4-23/32"	3500	2.43
3/8"	2-63/64"	5/8"	3/4"	5-3/4"	7100	4.41
1/2"	3-1/2"	3/4"	63/64"	6-27/32"	12000	6.83
5/8"	3-63/64"	55/64"	1-17/64"	8-5/64"	18100	11.68
3/4"	4-31/64"	63/64"	1-1/2"	9-1/4"	28300	20.06
7/8"	5"	1-1/8"	1-3/4"	10-3/8"	34200	26
1"	5-1/2"	1-1/4"	2-1/8"	11-9/16"	47700	36.8
1-1/4"	6"	1-3/8"	2-3/8"	12-7/8"	72300	58.4

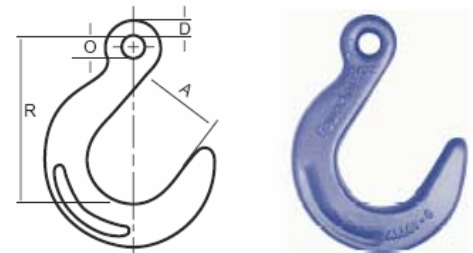

Never Exceed Working Load Limit



HALO

GRADE 80 CLEVIS SELF-LOCKING HOOK



Chain Size	A	B	P	R	W.L.L. (lbs.)	Wt. Ea. (lbs.)
9/32"-5/16"	1-5/64"	11/32"	23/64"	3-23/32"	3500	2.14
3/8"	1-1/2"	31/64"	33/64"	4-59/64"	7100	4.3
1/2"	1-13/16"	39/64"	5/8"	6-3/16"	12000	7.94
5/8"	2-1/4"	3/4"	53/64"	7-7/16"	18100	14.33

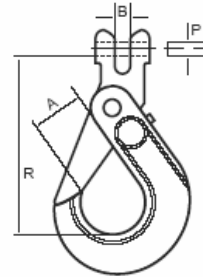

Never Exceed Working Load Limit

GRADE 80 COUPLING LINKS



Chain Size	A	B	C	D	E	W.L.L. (lbs.)	Wt. Ea. (lbs.)
9/32"	5/16"	1-59/64"	5/8"	25/32"	47/64"	3500	0.22
3/8"	15/32"	3-1/32"	7/8"	1-1/16"	63/64"	7100	0.77
1/2"	5/8"	3-11/32"	1-1/4"	1-17/64"	1-3/16"	12000	1.87
5/8"	25/32"	4-1/16"	1-17/32"	1-17/32"	1-27/64"	18100	2.43
3/4"	29/32"	4-9/16"	1-23/32"	1-55/64"	1-47/64"	28300	3.75
7/8"	1-1/16"	5-15/64"	2"	2-11/64"	1-59/64"	34200	4.85
1"	1-1/4"	6-15/16"	2-1/4"	2-27/32"	2-23/64"	47700	9.26
1-1/4"	1-17/32"	6-13/16"	2-5/8"	2-3/4"	2-31/64"	72300	17.2

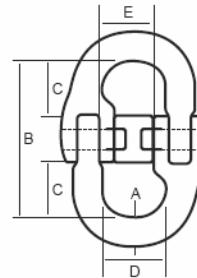

Never Exceed Working Load Limit



HALO

ALLOY CLEVIS GRAB HOOKS

KUPLEX® II



Made in USA



Hook No.	Chain Size	A	B	C	D	E	F	G	H	I	J	W.L.L. (lbs.)	Wt. Ea. (lbs.)
K-72	9/32"	11/16"	1-1/4"	2-1/8"	2-1/8"	3/8"	1/8"	5/16"	13/32"	11/32"	5/8"	4300	0.6
K-73	3/8"	1-1/32"	1-1/2"	2-7/8"	2-5/8"	1/2"	5/32"	7/16"	9/16"	15/32"	7/8"	8800	1.5
K-75	1/2"	1-1/4"	2"	3-9/16"	3-11/32"	5/8"	3/16"	9/16"	3/4"	21/32"	1-1/8"	15000	3.4
K-76	5/8"	1-5/8"	2-3/8"	4-5/16"	4-1/4"	25/32"	1/4"	11/16"	15/16"	13/16"	1-1/2"	22600	6.2
K-77	3/4"	1-7/8"	2-15/16"	5-3/32"	5-1/16"	7/8"	5/16"	13/16"	1-7/32"	1"	1-3/4"	28300	10.1
K-78	7/8"	2-1/8"	3-1/2"	5-7/8"	6-3/32"	1-1/8"	3/8"	15/16"	1-9/32"	1-1/16"	2"	34200	14.8

Never Exceed Working Load Limit

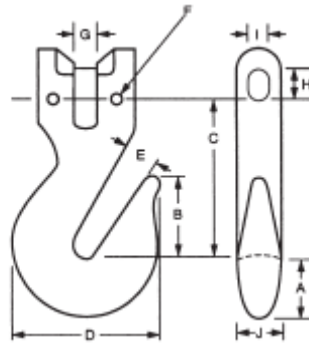

ALLOY SLING HOOKS WITH LATCH

KUPLEX® II



Made in USA



Hook No.	Chain Size	A	B	C	D	E	F	G	H	I	J	W.L.L. (lbs.)	Wt. Ea. (lbs.)
K-80	9/32"	1"	1-1/2"	3-5/16"	3-5/8"	1-1/8"	1/8"	5/16"	13/32"	11/32"	5/8"	4300	1.3
K-81	3/8"	1-9/32"	2-1/32"	4-25/32"	4-13/16"	1-5/8"	5/32"	7/16"	9/16"	15/32"	7/8"	8800	3.1
K-82	1/2"	1-11/16"	2-7/16"	6-1/8"	6-1/8"	2"	3/16"	9/16"	3/4"	21/32"	1-1/8"	15000	6.5
K-83	5/8"	1-15/16"	2-7/8"	6-13/16"	7-7/32"	2-7/16"	1/4"	11/16"	15/16"	13/16"	1-1/2"	22600	10.7
K-84	3/4"	2-3/8"	3-1/4"	8-17/32"	8-3/16"	2-11/16"	5/16"	13/16"	1-7/32"	1"	1-3/4"	28300	16.6
K-85	7/8"	2-3/4"	3-21/32"	9-5/8"	9-15/32"	3"	3/8"	15/16"	1-9/32"	1-1/16"	2"	34200	25.9
K-86	1"	2-11/16"	4-1/16"	10-1/16"	10-1/16"	3-3/8"	NA	1-3/8"	1-7/32"	1-3/32"	1-7/8"	35900	26.9

Never Exceed Working Load Limit

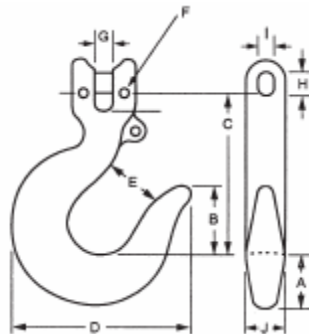



HALO

ALLOY CHAIN KUPLERS

KUPLEX® II



Made in USA



Kupler No.	Chain Size	A	B	C	D	E	G	H	I	J	W.L.L. (lbs.)	Wt. Ea. (lbs.)
K-20	9/32"	7/16"	13/16"	1-5/16"	5/16"	1/8"	23/32"	13/32"	11/32"	5/8"	4300	.3
K-21	3/8"	19/32"	1-1/16"	1-13/16"	7/16"	5/32"	7/8"	9/16"	15/32"	7/8"	8800	.7
K-22	1/2"	3/4"	1-5/16"	2-9/16"	9/16"	3/16"	1-3/32"	3/4"	21/32"	1-1/8"	15000	1.5
K-23	5/8"	15/16"	1-5/8"	3"	11/16"	1/4"	1-11/32"	15/16"	13/16"	1-1/2"	22000	3
K-24	3/4"	1"	1-15/16"	3-13/32"	13/16"	5/16"	1-19/32"	1-7/32"	1"	1-3/4"	28300	4.8
K-25	7/8"	1-1/8"	2-1/4"	3-7/8"	15/16"	3/8"	1-27/32"	1-9/32"	1-1/16"	2"	34200	6.1
K-26	1"	1-1/4"	2-11/16"	4-1/4"	1-1/16"	NA	2"	1-7/32"	1-3/32"	2-3/8"	35900	8.4
K-28	1-1/4"	1-1/2"	3-1/2"	5-1/8"	1-5/16"	NA	2-9/32"	1-1/2"	1-11/32"	2-7/8"	56100	14.8

Never Exceed Working Load Limit

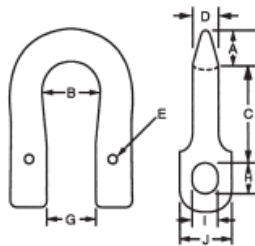

ALLOY MASTER KUPLINKS

KUPLEX® II



Made in USA



Kuplink No.	Chain Size	A	B	C	D	E	F	G	H	I	J	W.L.L. (lbs.)	Wt. Ea. (lbs.)
K-11	9/32"	3/4"	3"	6"	1/2"	7-1/8"	1/8"	5/16"	13/32"	11/32"	5/8"	4300	2.5
K-12	3/8"	3/4"	3"	6"	1/2"	7-1/4"	5/32"	7/16"	9/16"	15/32"	7/8"	8800	2.7
K-13	1/2"	15/16"	3"	6"	11/16"	7-9/16"	3/16"	9/16"	3/4"	21/32"	1-1/8"	15000	4.4
K-14	5/8"	1-1/8"	4"	8"	7/8"	9-15/16"	1/4"	11/16"	15/16"	13/16"	1-1/2"	22600	8.2
K-15	3/4"	1-1/4"	4"	8"	7/8"	10-3/16"	5/16"	13/16"	1-7/32"	1"	1-3/4"	28300	11.6

Never Exceed Working Load Limit

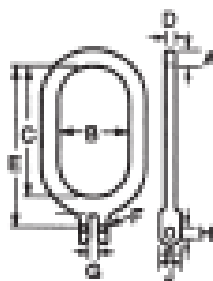



GRADE 80 COUPLING LINKS

KUPLEX® II



Made in USA

Chain Size	A	D	C	B	E	W.L.L. (lbs.)	Wt. Ea. (lbs.)
9/32"	5/16"	1-59/64"	5/8"	25/32"	47/64"	3500	0.22
3/8"	15/32"	3-1/32"	7/8"	1-1/16"	63/64"	7100	0.77
1/2"	5/8"	3-11/32"	1-1/4"	1-17/64"	1-3/16"	12000	1.87
5/8"	25/32"	4-1/16"	1-17/32"	1-17/32"	1-27/64"	18100	2.43
3/4"	29/32"	4-9/16"	1-23/32"	1-55/64"	1-47/64"	28300	3.75

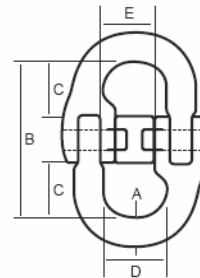

⚠ Never Exceed Working Load Limit

CHAIN SLING TAGS



Acco Chain sling tags come with piece of vinyl coated cable and aluminum sleeve for securing to the chain sling.



Made in USA



Stamped



YOKE GRADE 80 COUPLING LINKS



ABS
Type Approval



HALO

Yoke Part No.	Working	For	Dimensions (inch)				Wt.
	Load Limit	Grade 80					
	4:1 safety factor	Chain	K	A	D	B	Lbs
	Lbs	inch					
8-015-07	4,500	1/4-5/16	2.32	0.71	0.35	0.87	0.4
8-015-10	7,100	3/8	2.68	0.98	0.51	1.02	0.7
8-015-13	12,000	1/2	3.58	1.18	0.63	1.38	1.5
8-015-16	18,100	5/8	3.94	1.42	0.75	1.5	2.4
8-015-18/20	28,300	3/4	4.8	1.65	0.87	1.81	3.7
8-015-22	34,200	7/8	5.98	1.93	0.94	2.36	6.6
8-015-26	47,700	1	6.38	2.17	1.22	2.44	10.1
8-015-32	72,300	1 1/4	7.95	2.72	1.5	3.11	18.9

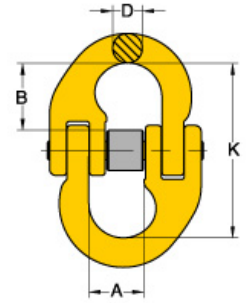

YOKE GRADE 80 OMEGA LINKS



Yoke Part No.	Working	For	Dimensions (inch)				Wt.
	Load Limit	Grade 80					
	4:1 safety factor	Chain	K	D	T	P	kg
	Lbs	inch					
8-018-07	4,500	1/4-5/16	1.41	1.06	0.44	0.35	0.88
8-018-10	7,100	3/8	1.73	1.26	0.59	0.47	1.76
8-018-13	12,000	1/2	2.16	1.65	0.67	0.62	2.2
8-018-16	18,100	5/8	2.71	1.96	0.89	0.71	6.6
8-018-18/20	28,300	3/4	2.79	2.28	1.1	0.79	11

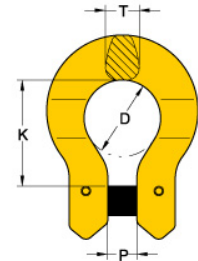

YOKE GRADE 80 CLEVIS SHACKLES



Yoke Part No.	Working	For	Dimensions (inch)						Wt.
	Load Limit	Grade 80							
	4:1 safety factor	Chain	K	L	W	G	M	C	Lbs
	Lbs*	inch							
8-066-07	4,500	1/4-5/16	2.32	1.38	1.3	1.34	0.63	3.11	0.8
8-066-10	7,100	3/8	3.07	1.89	1.46	1.57	0.79	3.66	1.8
8-066-13	12,000	1/2	3.86	2.25	1.93	1.73	0.87	4.65	2.8
8-066-16	18,100	5/8	4.41	2.72	2.36	2.13	1.1	5.55	5

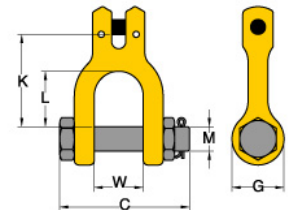



HALO

YOKE GRADE 80 CLEVIS GRAB HOOKS



Yoke Part No.	Working Load Limit	For Grade 80 Chain	Dimensions (inch)						Wt.
	4:1 safety factor		P	A	F	K	H	L	
	Lbs*	inch							
8-042-07	4,500	1/4-5/16	0.39	0.35	1.18	2.17	0.98	3.66	0.6
8-042-10	7,100	3/8	0.51	0.47	1.61	3.03	1.38	5.04	1.7
8-042-13	12,000	1/2	0.63	0.59	2.09	3.82	1.65	5.98	3.3
8-042-16	18,100	5/8	0.79	0.67	2.28	4.02	1.77	7.09	6.3
8-042-18/20	28,300	3/4	0.98	0.91	3.86	4.88	2.13	8.84	11

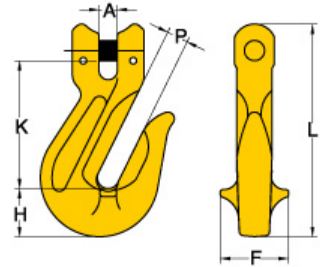

YOKE GRADE 80 EYE GRAB HOOKS



Yoke Part No.	Working Load Limit	For Grade 80 Chain	Dimensions (inch)					Wt.
	4:1 safety factor		K	A	G	K	F	
	Lbs*	inch						
8-041-07	4,500	1/4-5/16	0.39	0.59	0.35	2.36	1.18	0.4
8-041-10	7,100	3/8	0.51	0.79	0.51	3.31	1.61	1.3
8-041-13	12,000	1/2	0.63	0.98	0.59	4.02	2.05	2.6
8-041-16	18,100	5/8	0.79	1.18	0.79	4.49	2.24	5
8-041-20	28,300	3/4	0.91	1.42	0.91	5.2	3.86	10.1
8-041-22	34,200	7/8	1.06	1.5	1.02	6.18	4.33	18
8-041-26	47,700	1	1.14	1.61	1.26	7.36	3.94	21.5
8-041-32	72,300	1 1/4	1.46	2.24	1.57	9.06	3.54	42.7

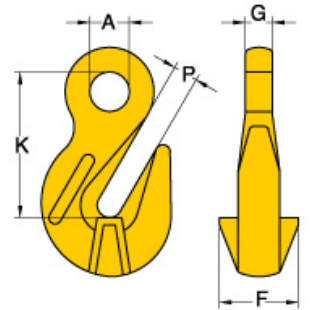

YOKE GRADE 80 CLEVIS SLING HOOKS



Item No.	Working Load Limit	For Grade 80 Chain	Dimensions (inch)				Wt.
	4:1 safety factor		K	P1	T	H	
	Lbs*	inch					
8-043/S-07	4,500	1/4-5/16	3.74	1.18	0.75	0.91	1.1
8-043/S-10	7,100	3/8	4.72	1.42	0.91	1.22	2.2
8-043/S-13	12,000	1/2	5.79	1.73	1.1	1.5	4.6
8-043/S-16	18,100	5/8	6.65	1.81	1.3	1.73	8.1
8-043/S-18/20	28,300	3/4	7.48	2.36	1.97	2.01	13.2

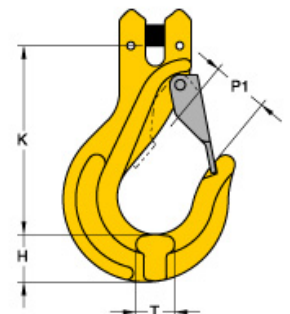



HALO

YOKE GRADE 80 EYE SLING HOOKS



ABS

Type Approval



Yoke Part No.	Working Load Limit 4:1 safety factor	For Grade 80 Chain inch	Dimensions (inch)						Wt. Lbs
	Lbs*		K	P1	A	D	T	H	
8-044-/S-07	4,500	1/4-5/16	3.86	1.18	0.98	0.43	0.75	0.91	0.8
8-044-/S-10	7,100	3/8	4.76	1.42	1.26	0.59	1.91	1.22	1.9
8-044-/S-13	12,000	1/2	5.98	1.69	1.57	0.71	1.1	1.5	3.7
8-044-/S-16	18,100	5/8	7.2	1.85	1.97	0.87	1.29	1.85	6.9
8-044-/S-18/20	28,300	3/4	8.54	2.05	2.36	1.06	1.69	1.89	11.4
8-044-/S-22	34,200	7/8	9.45	2.75	1.97	1.26	1.97	2.91	18.7
8-044-/S-26	47,700	1	10.63	3.15	2.6	1.34	2.36	3.15	27.9
8-044-/S-32	72,300	1 1/4	12.6	3.54	3.5	1.46	2.56	3.58	36.3

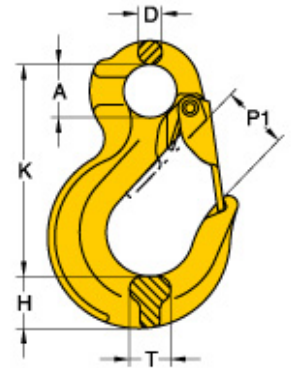

YOKE GRADE 80 CLEVIS SELF-LOCKING HOOKS



Yoke Part No.	Working Load Limit 4:1 safety factor	For Grade 80 Chain inch	Dimensions (inch)				Wt. Lbs
	Lbs*		K	P	T	H	
8-026-07	4,500	1/4-5/16	4.69	1.34	0.75	0.94	1.7
8-026-10	7,100	3/8	5.63	1.73	0.94	1.22	3.3
8-026-13	12,000	1/2	7.05	2.05	1.06	1.57	6.1
8-026-16	18,100	5/8	8.35	2.36	1.42	2.09	12.3
8-026-18/20	28,300	3/4	12.56	3.54	1.93	2.8	16.5

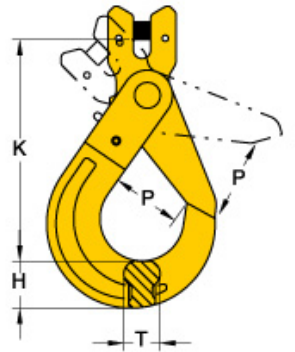

YOKE GRADE 80 EYE SELF-LOCKING HOOKS



ABS

Type Approval



Yoke Part No.	Working Load Limit 4:1 safety factor	For Grade 80 Chain inch	Dimensions (inch)						Wt. Lbs
	Lbs*		K	P	A	D	T	H	
8-025-07	4,500	1/4-5/16	5.35	1.34	0.98	0.44	0.79	0.94	1.7
8-025-10	7,100	3/8	6.57	1.73	1.26	0.51	1.02	1.19	3
8-025-13	12,000	1/2	8.15	2.05	1.56	0.62	1.19	1.5	5.9
8-025-16	18,100	5/8	9.92	2.36	2.05	0.83	1.56	1.91	12.3
8-025-18/20	28,300	3/4	11.1	3.54	2.52	0.91	1.91	1.96	18.7
8-025-22	34,200	7/8	12.56	3.15	2.75	0.94	1.93	2.48	23.8
8-025-26	47,700	1	13.5	3.9	3.15	0.98	2.2	2.72	29.5

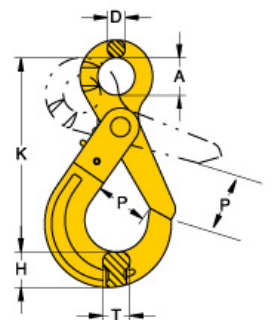



GRADE 80 EYE SWIVEL SELF-LOCKING HOOKS

* Swivel is fitted with bronze bushing.



HALO

Yoke Part No.	Working Load Limit	For Grade 80 Chain	Dimensions (inch)							Wt.
	4:1 safety factor		Lbs*	inch	K	P	B	A	D	T
8-02707	4,500	1/4-5/16	7.32	1.34	1.14	1.42	0.55	0.79	0.98	2.4
8-027-10	7,100	3/8	8.66	1.73	1.34	1.57	0.63	1.02	1.22	4.4
8-027-13	12,000	1/2	10.51	2.05	1.69	1.81	0.87	1.34	1.57	8.8
8-027-16	18,100	5/8	12.91	2.36	2.05	2.36	0.94	1.61	2.05	14.9
8-027-18/20	28,300	3/4	15.28	3.54	3.23	2.95	1.02	1.89	2.44	25.5
8-027-22	34,200	7/8	18	3.15	3.74	3.82	1.3	1.93	2.48	35.2
8-027-26	47,700	1	21.06	3.9	4.53	4.84	1.65	2.24	3.03	47.4

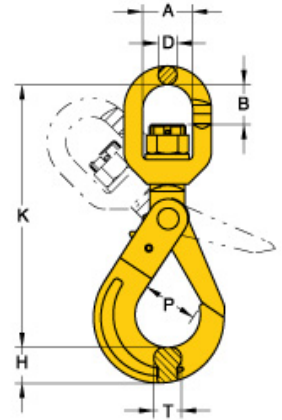

YOKE GRADE 80 EYE FOUNDRY HOOKS



Yoke Part No.	Working Load Limit	For Grade 80 Chain	Dimensions (inch)							Wt.
	4:1 safety factor		Lbs*	inch	K	P	A	D	T	H
8-047-07	4,500	1/4-5/16	4.8	2.4	0.94	0.47	0.79	1.18	1.5	
8-047-10	7,100	3/8	5.91	2.91	1.22	0.59	0.96	1.34	2.6	
8-047-13	12,000	1/2	7.09	3.46	1.57	0.79	1.34	1.65	5	
8-047-16	18,100	5/8	8.46	3.86	1.93	0.94	1.69	1.97	8.8	
8-047-18/20	28,300	3/4	9.76	4.41	2.36	1.1	1.81	2.24	13.2	

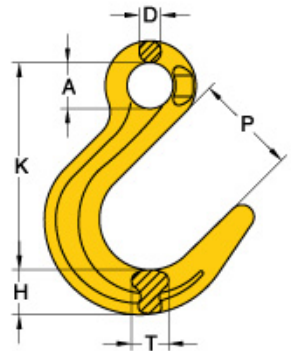

YOKE GRADE 80 CLEVIS CLUTCH



Yoke Part No.	Working Load Limit	For Grade 80 Chain	Dimensions (inch)						Wt.
	4:1 safety factor		Lbs*	inch	A,B	C	D	E	F
8-060-07	4,500	1-4-5/16	0.34	0.39	0.35	0.63	2.44	0.8	
8-060-10	7,100	3/8	0.49	0.55	0.47	0.98	3.43	2	
8-060-13	12,000	1/2	0.65	0.67	0.59	1.26	4.53	4.2	
8-060-16	18,100	5/8	0.81	0.75	0.75	1.54	5.63	6.9	
8-060-18/20	28,300	3/4	0.85	0.91	0.87	1.81	5.98	13.6	

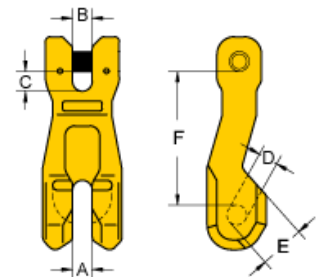



YOKE GRADE 80 MASTER LINKS WITH FLAT



HALO

- Proof tested and certified. 5:1 safety factor.
- Drop forged.

Yoke Part No.	Trade	Chain Size		Working	Dimensions (inch)			N.W.
	Size	(inch)		Load Limit	IL	IW	D	Lbs
	inch	1-Leg		Lbs*				
8-003F-0806 *	1/2"	1/4~5/16		7,000	4.72	2.76	0.55	0.8
8-003F-1008 *	5/8"	3/8	1/4~5/16	9,000	5.55	3.15	0.67	1.5
8-003F-1310 *	7/8"	1/2	3/8	14,000	6.42	3.74	0.91	3.3
8-003F-1613 *	1-1/8"	5/8	1/2	30,000	7.2	4.13	1.14	5.9
8-003F-2216 *	1-3/8"	3/4	5/8	42,000	9.65	5.51	1.36	11.2
8-003F-2619 *	1-5/8"	1	3/4	66,000	10.12	5.89	1.57	17.6

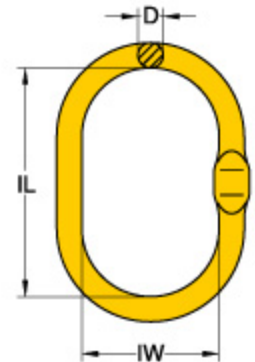

YOKE GRADE 80 MASTER LINK SUBASSEMBLIES



- For chain slings only.
- Proof tested and certified.
- 4:1 safety factor.

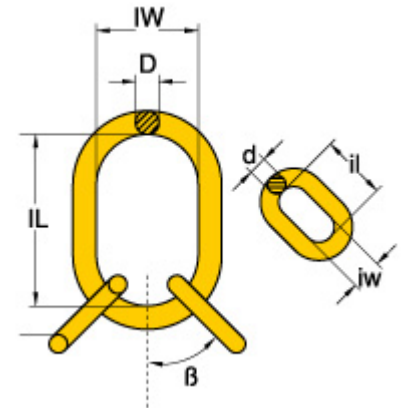

Yoke Part No.	WLL(Lbs)	WLL(Lbs)	For	Dimensions (inch)						Wt.
	at 0-45 degrees	at 45-60 degrees	Grade 80	D	IW	IL	d	iw	il	Lbs
		Chain (inch)								
			3 or 4 Legs							
8-008-08	10,100	7,900	1/4~5/16	0.79	3.54	6.3	0.51	1.38	2.36	3.7
8-008-10	17,200	12,500	3/8	1	4.02	7.48	0.63	1.57	3.15	7.3
8-008-13	30,800	26,600	1/2	1.26	5.51	9.45	0.87	1.97	3.54	15
8-008-16	54,600	46,300	5/8	1.57	6.1	11.02	1.1	2.36	3.94	27.5
8-008-20	73,400	56,000	3/4	1.77	6.89	12.6	1.26	2.95	4.92	36.3
8-008-22	81,800	81,800	7/8	1.97	7.68	13.78	1.57	3.15	5.51	60.5
8-008-26	110,200	110,200	1	2.36	8.66	16.14	1.77	3.54	6.5	96.8
8-008-32	164,900	146,100	1 1/4	2.76	9.84	17.72	1.97	3.94	7.68	143.9



HALO

YOKE LATCH KITS FOR SLING HOOKS



Yoke Part No.	Size
	inch
8-P044-07	1/4~5/16
8-P044-10	3/8
8-P044-13	1/2
8-P044-16	5/8
8-P044-18/20	3/4
8-P044-22	7/8
8-P044-26	1
8-P044-32	1 1/4

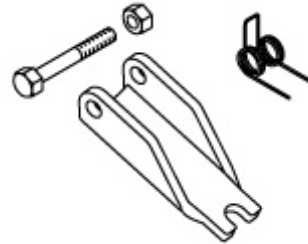

YOKE REPLACEMENT COUPLING PIN & SLEEVE SETS



Yoke Part No.	Size	Working Load Limit
	inch	Lbs
8-P015-07	1/4~5/16	4,500
8-P015-10	3/8	7,100
8-P015-13	1/2	12,000
8-P015-16	5/8	18,100
8-P015-18/20	3/4	28,300
8-P015-22	7/8	34,200
8-P015-26	1	47,700
8-P015-32	1 1/4	72,300

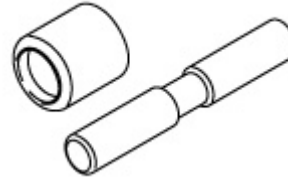

YOKE REPLACEMENT LOAD PIN KITS



Yoke Part No.	Size	Working Load Limit
	inch	Lbs
8-P026-07	1/4~5/16	4,500
8-P026-10	3/8	7,100
8-P026-13	1/2	12,000
8-P026-16	5/8	18,100
8-P026-18/20	3/4	28,300

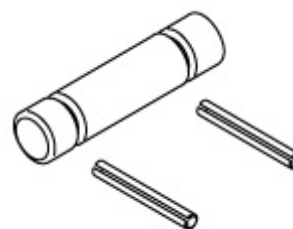



HALO

YOKE TRIGGER KITS FOR SELF-LOCKING HOOKS



Yoke Part No.	Size
	inch
8-P025-07	1/4~5/16
8-P025-10	3/8
8-P025-13	1/2
8-P025-16	5/8
8-P025-18/20	3/4
8-P025-22	7/8
8-P025-26	1
8-P025-32	1 1/4

